

**EASY TO
BUILD KIT . . .
Includes**

**COMPLETELY INSTALLED
ENGINE**

**PRE-INSTALLED
BRAKE, THROTTLE AND
SPROCKET SYSTEMS**

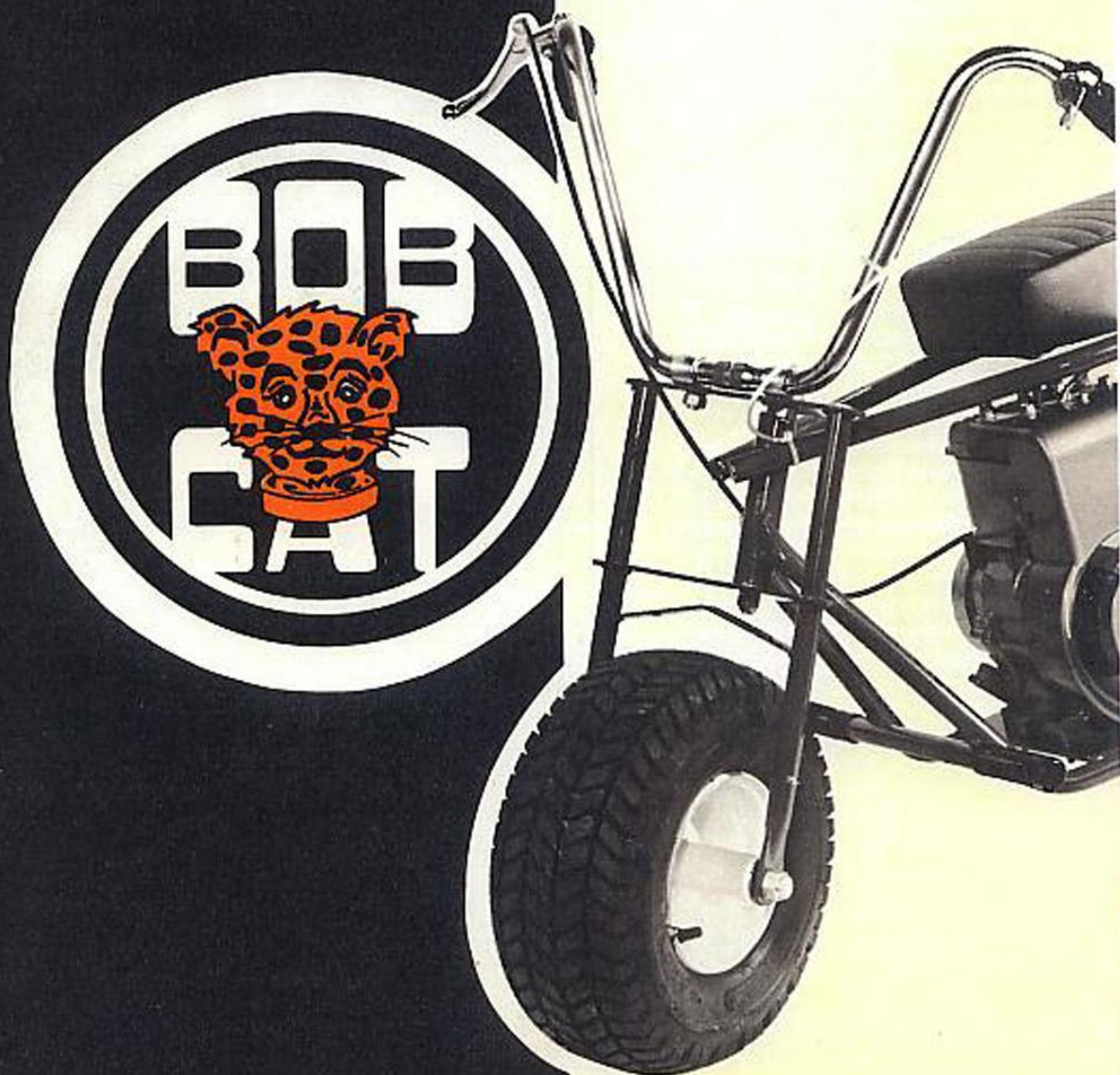



STRIKE OUT for parts unknown!



1. Read instructions through completely!
2. Remove parts from carton. Refer to check list before assembly to determine missing parts.
3. Identify parts with exploded view of bike.
4. Install Front Fork . . . 1/2" bolt, insert down through fork & neck bearing—see view 1
5. Install Front and Rear wheels. Secure axle bolts with self-locking nuts.
- CAUTION—DO NOT OVER TIGHTEN, MAY DAMAGE BEARINGS. See view 2
6. Install Kickstand—see view 3
7. Install Chain—chain should roll on the top side of idler pulley—see view 4
8. Move engine forward and secure with self-locking nuts—see view 5
- CAUTION—DO NOT EXERT EXTREME PRESSURE ON ENGINE (WHEN ENGINE IS PROPERLY LOCATED AND TIGHTENED, CHAIN SHOULD HAVE ABOUT A 1/8" OF PLAY)—OVERTIGHTEN MAY DAMAGE THE CLUTCH—

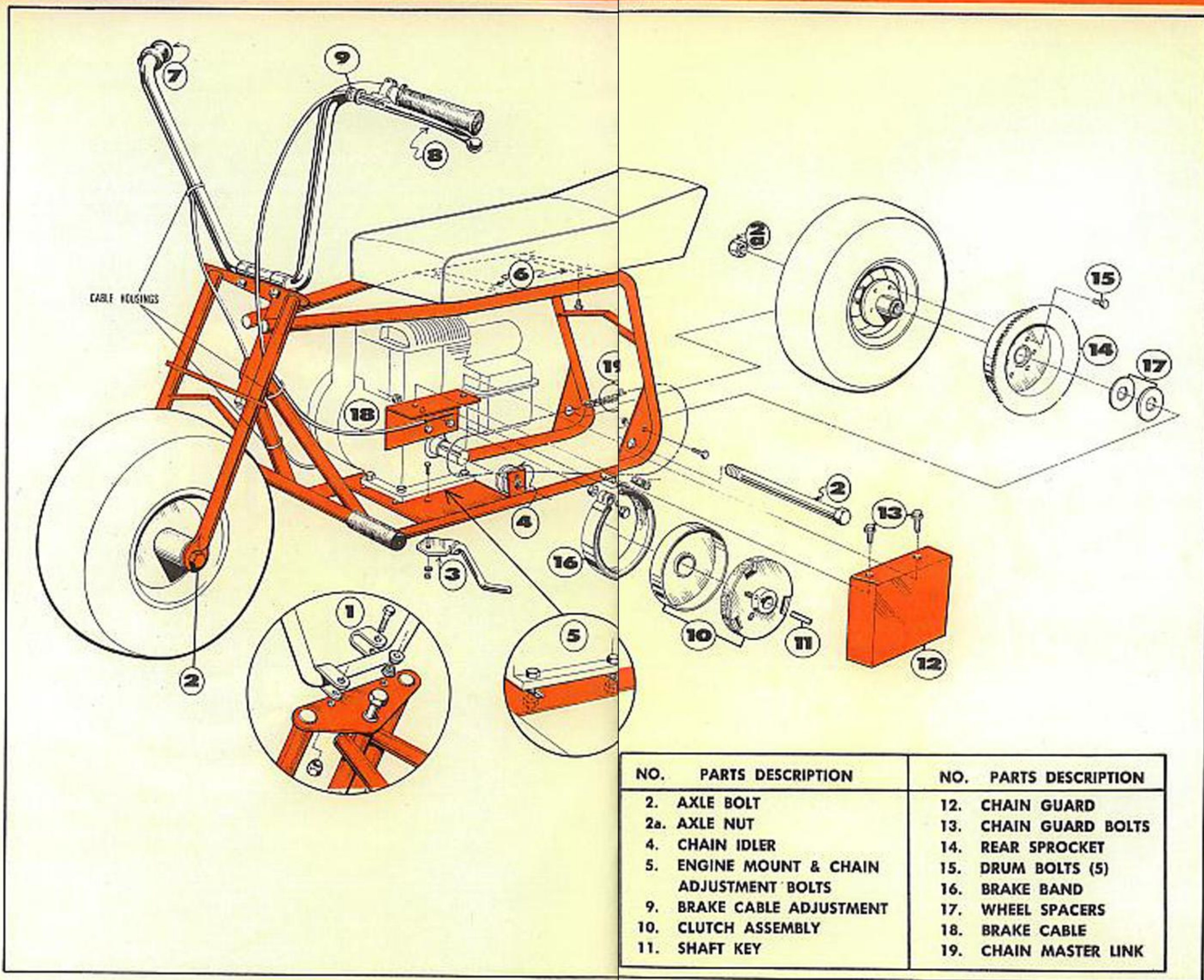

9. Install Seat—see view 6
10. Install Handle Bar—see view 1
11. Attach Throttle to Handle Bar—see view 7
12. Attach Brake Control to Handle Bar—see view 8
13. Secure Control Cable Housings.
14. Make necessary final adjustments on throttle to insure freedom of movement and throttle valve in idle position. Operate several times to determine performance of full range—from idle to wide open throttle.
15. Install Clutch Guard—see view.
16. Check Brake Control for proper stopping action. Brake control should cause a braking action before reaching the completely depressed position.
17. Consult Manufacturer's Instruction & Operating Manual before operating engine. Failure to do so may void warranty.
18. Double check all the above procedures and check all nuts and bolts to assure a ready to use bike.
19. Your 'Bobcat' is now ready to take on trails and provide hours of safe enjoyment.

NO.	PARTS DESCRIPTION	NO.	PARTS DESCRIPTION
2.	AXLE BOLT	12.	CHAIN GUARD
2a.	AXLE NUT	13.	CHAIN GUARD BOLTS
4.	CHAIN IDLER	14.	REAR SPROCKET
5.	ENGINE MOUNT & CHAIN ADJUSTMENT BOLTS	15.	DRUM BOLTS (5)
9.	BRAKE CABLE ADJUSTMENT	16.	BRAKE BAND
10.	CLUTCH ASSEMBLY	17.	WHEEL SPACERS
11.	SHAFT KEY	18.	BRAKE CABLE
		19.	CHAIN MASTER LINK

SPECIFICATIONS

WHEEL BASE	38"	TUBING — FRAME	7/8 .095 WALL
OVERALL LENGTH	53"	TUBELESS TIRES	15 x 6.00 x 6 GOODYEAR
WIDTH	32"	BRAKES	CLUTCH BRAKE
WEIGHT	95 lbs.	ENGINE	5 H.P. BRIGGS & STRATTON
GROUND CLEARANCE	5 1/8"	CLUTCH	MAXTORQUE
SEAT FROM GROUND	23"	BEARINGS	SEALED
GEAR RATIO	6.5 to 1	CHAIN	ASA 35
SPEED	35 MPH	HARDWARE	HEAT TREATED

Bobcat



features

WIDE TRACTION TIRES

HEAVY DUTY CONSTRUCTION

POWERFUL 5 H.P. ENGINE

COMFORTABLE SEAT

LONG WHEEL BASE FOR EASIER RIDING & HANDLING

COLLAPSIBLE HANDLE BAR FOR TRANSPORTING & STORAGE

LOW MAINTENANCE DESIGN

BAKED ENAMEL WITH PRIMER BASE

AUTOMATIC CLUTCH

CHOICE OF TWO COLORS — YELLOW OR ORANGE

**NOT
RECOMMENDED
FOR
HIGHWAY
USE**

PARTS CHECK LIST

1	FORK	4	SEAT BOLTS
1	CLUTCH GUARD WITH 2 METAL SCREWS	2	AXLE NUTS & BOLTS
1	HANDLE BAR	1	NECK BOLT AND NUT
1	MASTER CHAIN LINK	1	SEAT
1	PRE-ASSEMBLED BASIC FRAME	1	FRONT TIRE
	CONTROL CABLE HOUSINGS	1	REAR TIRE



HARRISON RESEARCH, INC.

50575 RYAN RD.

UTICA, MICHIGAN 48087

PHONE: (313) 731-5430

WIDE TRACTION TIRES
LOW MAINTENANCE DESIGN
LUXURIOUS SEAT FOR TWO
HEAVY-DUTY CONSTRUCTION
BAKED ENAMEL WITH PRIMER BASE
FRONT TIRE CONVERTS TO SNOW-BIKE
LONG WHEEL BASE FOR EASY HANDLING
COLLAPSIBLE HANDLE BAR
4 H.P. TECUMSEH ENGINE/ALTERNATOR
AUTOMOTIVE TYPE BRAKE
PAINTED FRAME, FENDERS, CHAIN GUARD
AVAILABLE IN RED OR BLUE



MODEL 100

***\$239.95**



WIDE TRAC

WIDE TRACTION TIRES
LOW MAINTENANCE DESIGN
LUXURIOUS SEAT FOR TWO
HEAVY-DUTY CONSTRUCTION
FRONT TIRE CONVERTS TO SNOW-BIKE
LONG WHEEL BASE FOR EASY HANDLING
COLLAPSIBLE HANDLE BAR
4 H.P. TECUMSEH ENGINE/ALTERNATOR
AUTOMOTIVE TYPE BRAKE
BAKED ENAMEL WITH PRIMER BASE
PAINTED FRAME -- ORANGE - YELLOW
CHROME FENDERS & CHAIN GUARD



MODEL 100 deluxe *\$249.95

OPTIONAL POWER EQUIPMENT

TORQUE CONVERTER

Optional power equipment for that "go anywhere—do anything" power. Will adapt to all Wildcat Mini-Bikes. Easy to install — includes all necessary parts.

\$39.95

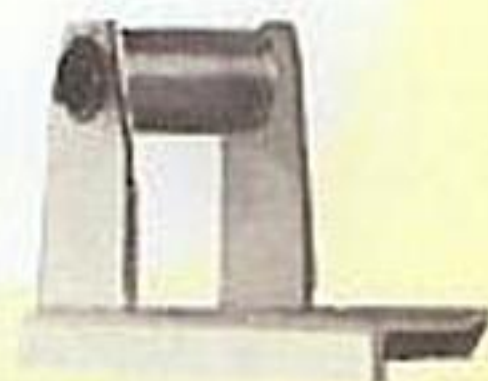
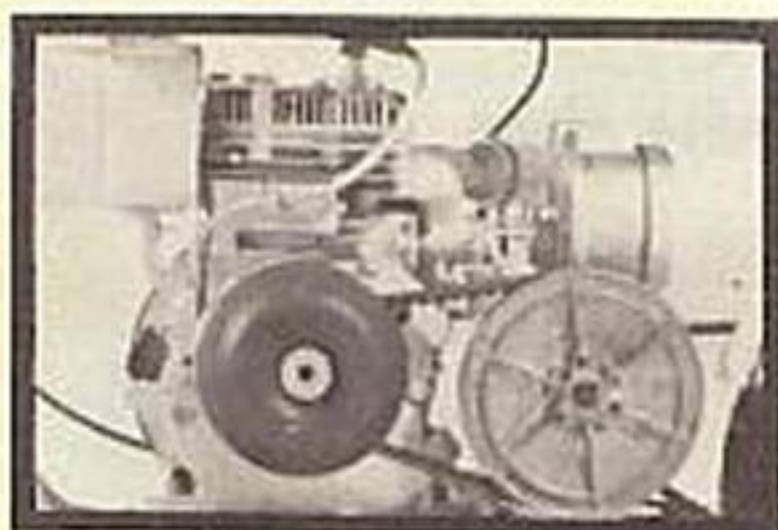

CONVERTER MOUNT

**SIMPLIFIES INSTALLATION AND
GUARANTEES ALIGNMENT - \$18.95**

1. READ INSTRUCTIONS through completely.

2. Remove parts from carton. REFER TO CHECK LIST before assembly

3. IDENTIFY PARTS with exploded view of bike.

15. ATTACH THROTTLE CONTROL to handle bar.

16. ATTACH BRAKE CONTROL to handle bar.

9. INSTALL BRAKE ASSEMBLY on mid-shaft. Secure to converter mount by installing through hole provided.

10. INSTALL SPROCKET on mid-shaft in front of brake assembly.

"This 'BOBCAT SCRAMBLER' is a real TIGER."

says
MICKEY LOLICH
pitching hero



14. INSTALL HANDLE BAR. Attach lower half of holder first, then insert bar and attach upper portion.



4. INSERT UPPER and LOWER NECK bearing.



5. INSTALL FRONT FORK . . . 1/2" bolt, insert down through fork and neck bearing.



17. Secure Brake and Throttle Control Cable Housings with plastic tie-downs.

12. Move engine forward and secure with self-locking nuts. See view
CAUTION - DO NOT EXERT EXTREME PRESSURE ON ENGINE. WHEN ENGINE IS PROPERLY LOCATED, CHAIN SHOULD HAVE ABOUT A 1/8" OF PLAY. OVERTIGHTENING MAY DAMAGE THE CONVERTER

13. INSTALL SEAT with four bolts.



11. INSTALL CHAIN to REAR SPROCKET
Check alignment. Check tension - chain should have a 1/2" of play.

7. INSTALL FRONT and REARWHEELS. Secure axle bolts with self-locking nuts. CAUTION - DO NOT OVERTIGHTEN - MAY DAMAGE BEARINGS -

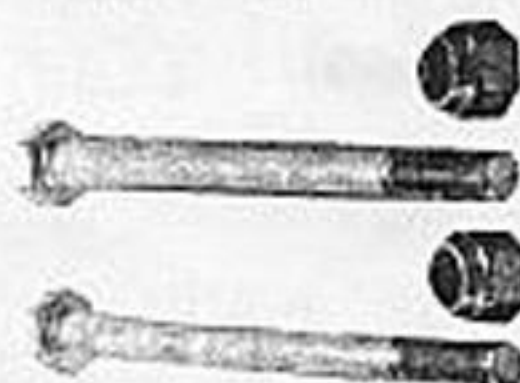

6. INSTALL FRONT & REAR FENDERS. Secure with self-locking nuts and bolts.



8. INSTALL KICK STAND.

18. INSTALL CONVERTER GUARD with two self-tapping metal screws.



19. INSTALL SAFETY GUARD with two nuts and bolts.

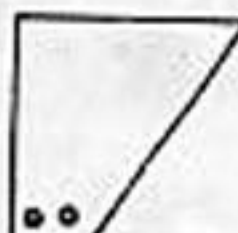

20. Make necessary final adjustments on throttle to insure freedom of movement and throttle valve in idle position. Operate several times to determine performance of full range - from idle to wide-open throttle.

21. Check brake control for proper stopping action. Brake control should cause a braking action BEFORE reaching the completely depressed position.

22. Consult Manufacturer's INSTRUCTION and OPERATING MANUAL BEFORE OPERATING THE ENGINE. Failure to do so may VOID WARRANTY.

23. Double check all the above procedures and check all nuts and bolts to assure a ready-to-use bike.

24. Your 'BOBCAT SCRAMBLER' is now ready to provide hours of safe and enjoyable trail riding.

SPECIFICATIONS

WHEEL BASE	38"	TUBING-FRAME	7/8" .095 WALL
OVERALL LENGTH	53"	TUBELESS TIRES	15 x 6.00 x 6 GOODYEAR
WIDTH	32"	BRAKES	CLUTCH BRAKE
WEIGHT	115 lbs.	ENGINE	4 H.P. TECUMSEH/ALTERNATOR
GROUND CLEARANCE	5-1/8"	CLUTCH	TORQUE CONVERTER
SEAT FROM GROUND	23"	BEARINGS	SEALED
GEAR RATIO	VARIABLE	CHAIN	ASA 35
SPEED	35 MPH	HARDWARE	HEAT TREATED

BOBCAT SCRAMBLER FEATURES

- WIDE TRACTION TIRES
- HEAVY DUTY CONSTRUCTION
- 4 H.P. ENGINE WITH ALTERNATOR
- COMFORTABLE SEAT
- LONG WHEEL BASE FOR EASIER RIDING & HANDLING
- COLLAPSIBLE HANDLE BAR FOR TRANSPORTING & STORAGE
- LOW MAINTENANCE DESIGN
- SALSBURY TORQUE CONVERTER
- COLOR - ORANGE

1	FORK ASSEMBLY	1	SAFETY GUARD/BOLTS
1	NECK BOLT & NUT	1	LENGTH CHAIN
1	HANDLE BAR	1	MASTER LINK
2	HANDLE BAR HOLDERS	2	AXLE BOLTS & NUTS
1	PRE-ASSEMBLED FRAME	1	FRONT TIRE
1	FOAM SEAT	1	REAR TIRE/SPROCKET
4	SEAT BOLTS	1	BRAKE CABLE/HOUSING
2	CHROME FENDERS/BOLTS	1	THROTTLE CABLE/HOUSING
1	CLUTCH GUARD/SCREWS		PLASTIC TIE-DOWNS

PARTS CHECK LIST

HARRISON RESEARCH, INC.
ORDER BLANK

NAME _____
 ADDRESS _____
 CITY _____ STATE _____ ZIP _____
 PHONE: AREA CODE _____ NO. _____

Check one:

- Please ship freight paid, certified check enclosed.
 Please ship C.O.D. - F.O.B. Utica -- 50% deposit enclosed.

ACCESSORIES:

- Light Kit - \$18.95 Passenger Footrest - \$2.95 Windshield - \$15.95

MAIL TO:

HARRISON RESEARCH, INC.
50575 RYAN ROAD
UTICA, MICHIGAN 48087
PHONE: (313) 731-5430

ALL ORDERS MUST BE ACCOMPANIED BY EITHER CERTIFIED CHECK OR MONEY ORDER.

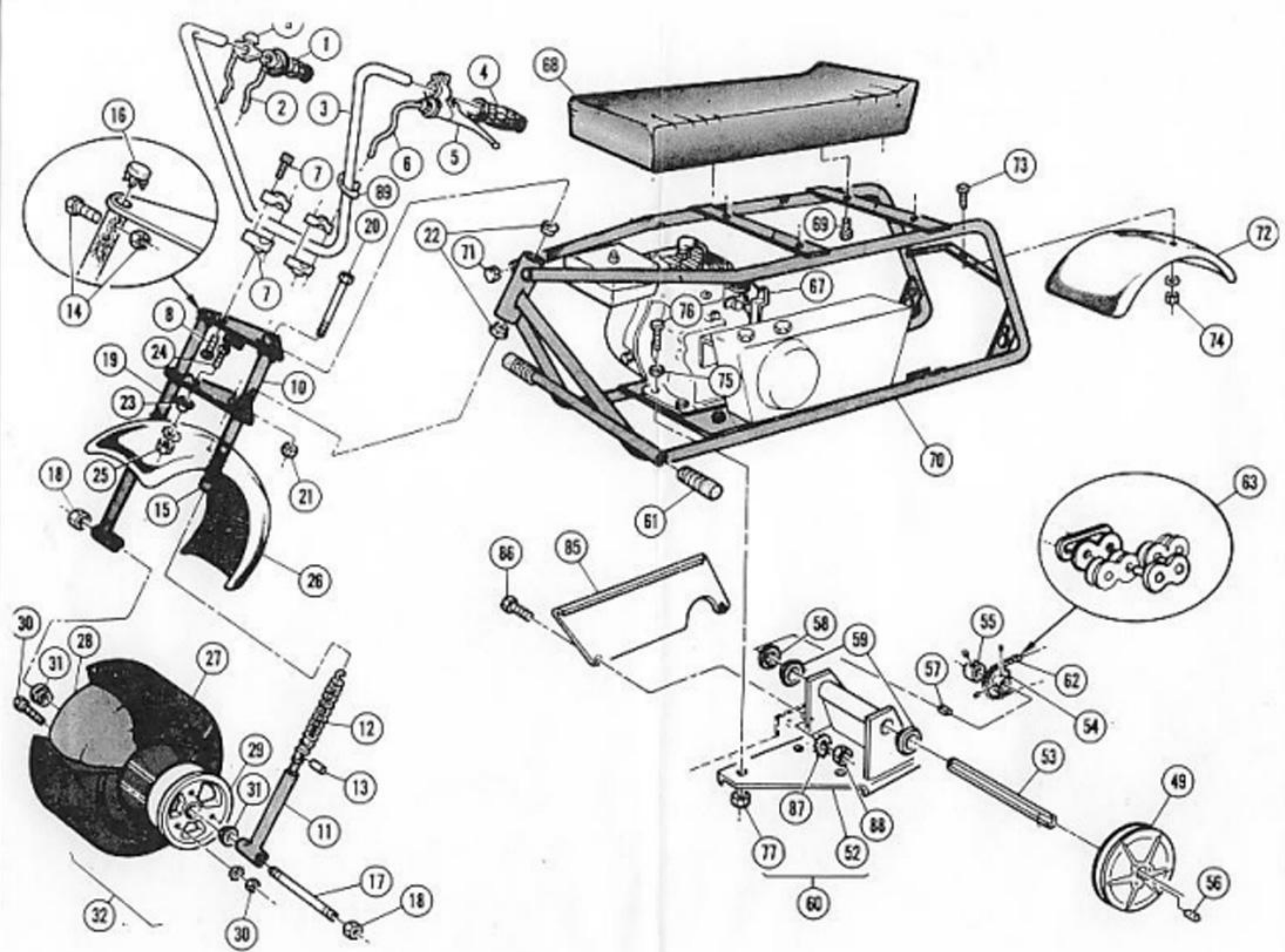

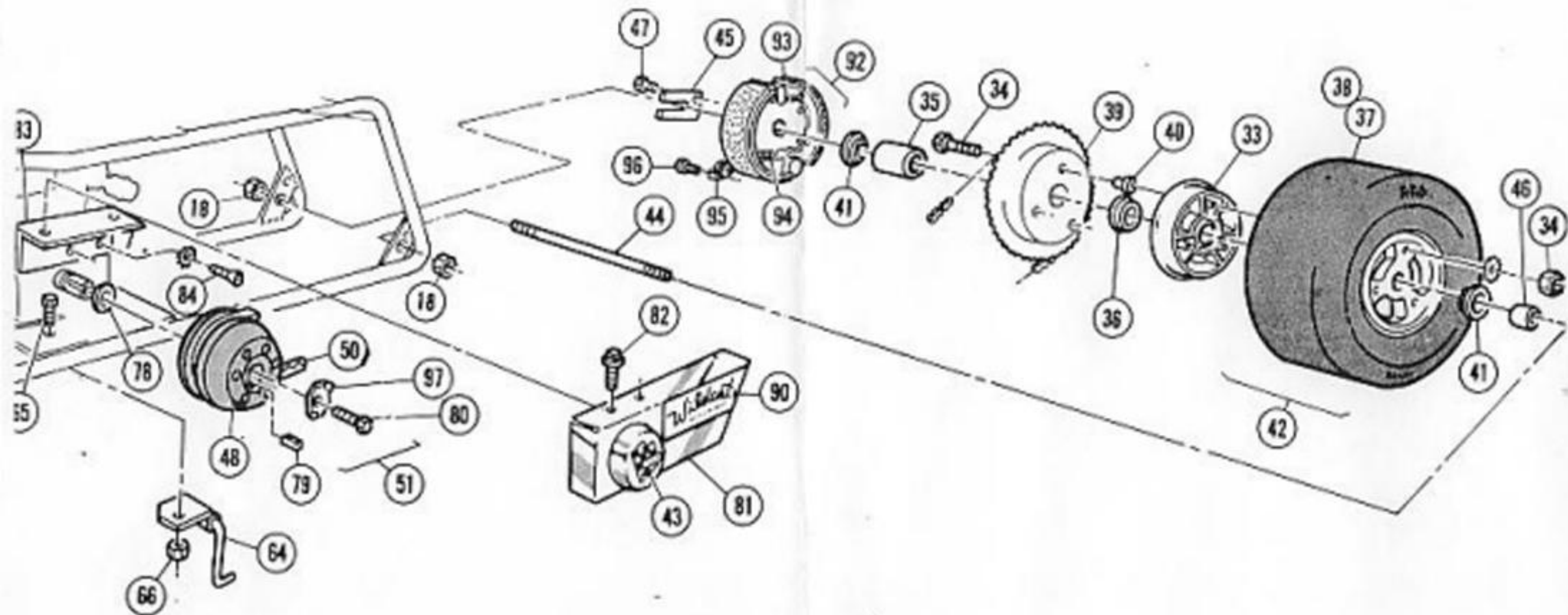

ENGINE BOLTS (4) ARE LOOSENED
AND CHAIN ADJUSTMENT IS MADE
BY MOVING ENGINE.

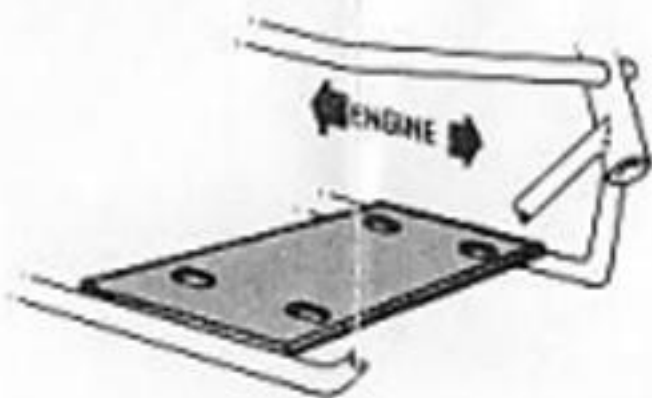

CHAIN ADJUSTMENT

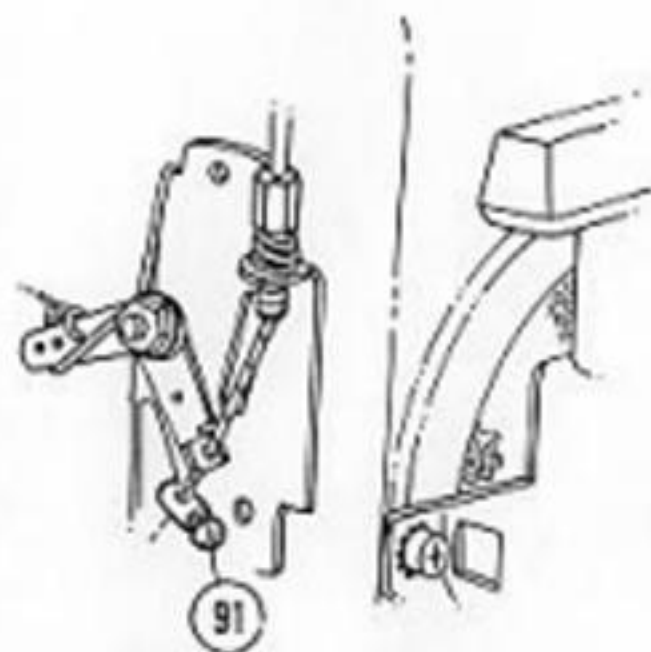

THROTTLE ASSY.

Wildcat
Model 400

SPECIFICATIONS

MODEL	ENGINE	CLUTCH	GEAR RATIO	BRAKES	SPEED	CHAIN	WEIGHT	STANDARD ON ALL MODELS
100	4 H.P. Tecumseh	4" Maxtorque	6.5 to 1	Expansion Shoe	30 MPH	35 ASA	110	Heat-Treated Hardware Sealed Bearings 15 x 6.00 x 6 Tubeless Tires Frame Tubing 7/8" .095 Wall Seat From Ground - 23" Ground Clearance - 5 1/8" Wheel Base - 38" Overall Length - 53" Width - 32"
100 Deluxe	4 H.P. Tecumseh	4" Maxtorque	6.5 to 1	Expansion Shoe	30 MPH	35 ASA	110	
300	4 H.P. Tecumseh	Torque Converter	Variable	Expansion Shoe	35 MPH	35 ASA	115	
300 Deluxe	4 H.P. Tecumseh	Torque Converter	Variable	Expansion Shoe	35 MPH	35 ASA	115	
Bobcat	4 H.P. Tecumseh	4" Maxtorque	6.5 to 1	Clutch Brake	30 MPH	35 ASA	105	

ACCESSORIES



CHROME ACCESSORIES - FOR THAT EXTRA-SPECIAL LOOK - INCLUDES FENDERS AND CHAIN GUARD - \$18.50



WINDSHIELD - DURABLE LIGHTWEIGHT PLASTIC EASY TO INSTALL - \$15.95



LIGHT KIT - INCLUDES HEADLAMP TAIL AND BRAKELIGHT, AND PLATE BRACKET - \$16.95 FOR ALTERNATOR - \$18.95



SKI ATTACHMENT FOR SNOW AND ICE HIGH-IMPACT PLASTIC - \$29.95



PASSENGER FOOTREST - EASY TO INSTALL - EXTRA COMFORT AND SAFETY - \$2.95



REMOTE MOUNT FUEL TANK IDEAL FOR INCREASING FUEL CAPACITY OR CUSTOMIZING - \$16.95

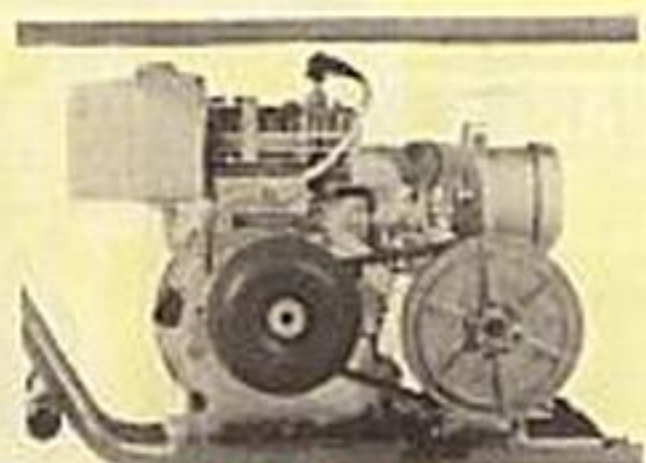

TORQUE CONVERTER - THE ANSWER FOR CLIMBING POWER OR SPEED (SEE CENTER INSET) - \$39.95



SHORT SEAT - ONLY 18" LONG - PERFECT COMPANION FOR REMOTE FUEL TANK - \$12.95



SCRAMBLER

by HARRISON RESEARCH INC.



\$199.95

F.O.B. H.R.I.

easy to build

FACTORY INSTALLED . . .

engine and mini-verter

HARRISON RESEARCH, INC.

50575 RYAN ROAD

UTICA, MICHIGAN 48087

PHONE: (313) 731-5430