

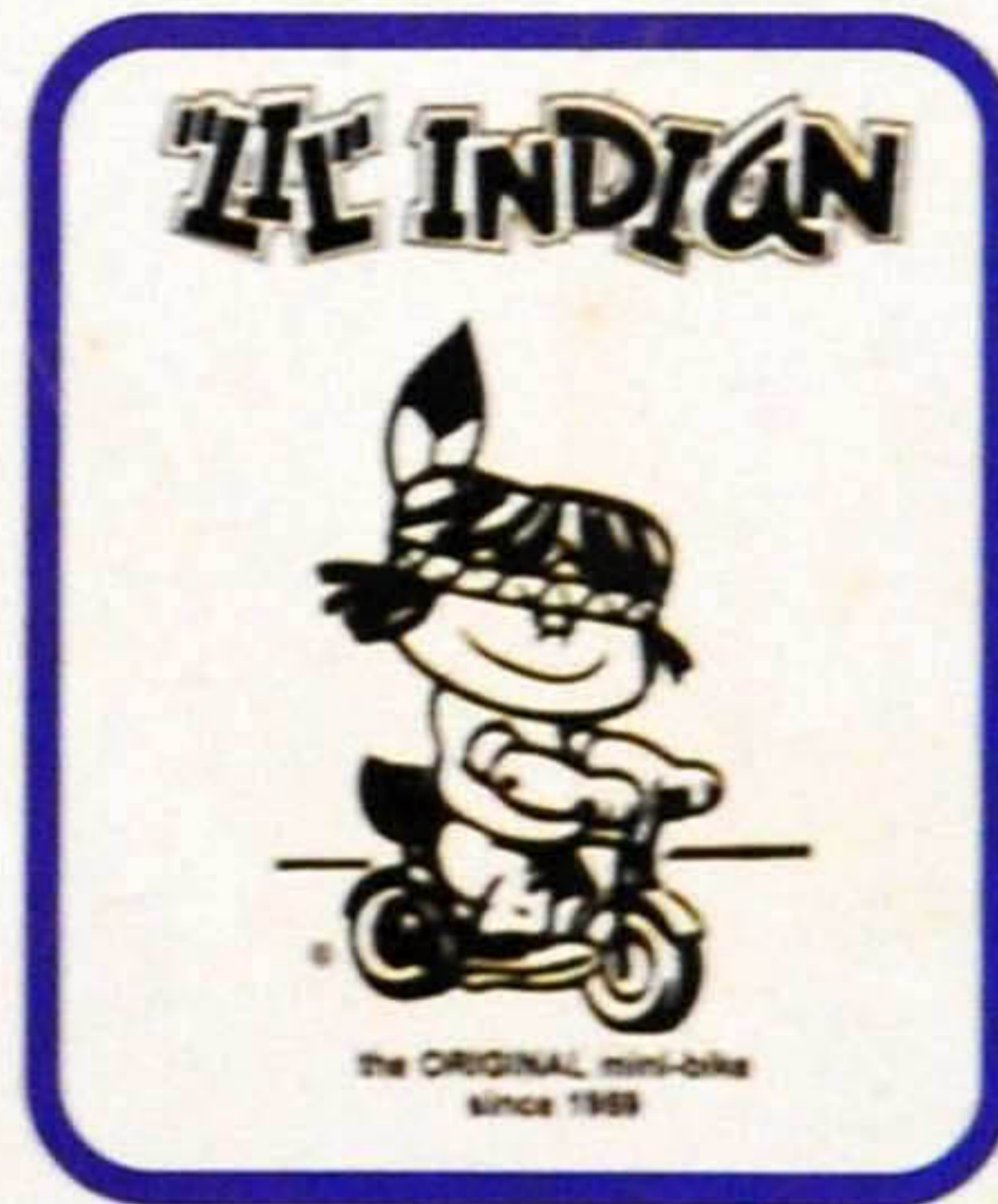

RECREATIONAL LEISURE CORP.

1971
2002

ATV,
Mini-Bike
and
Go-Kart
Parts

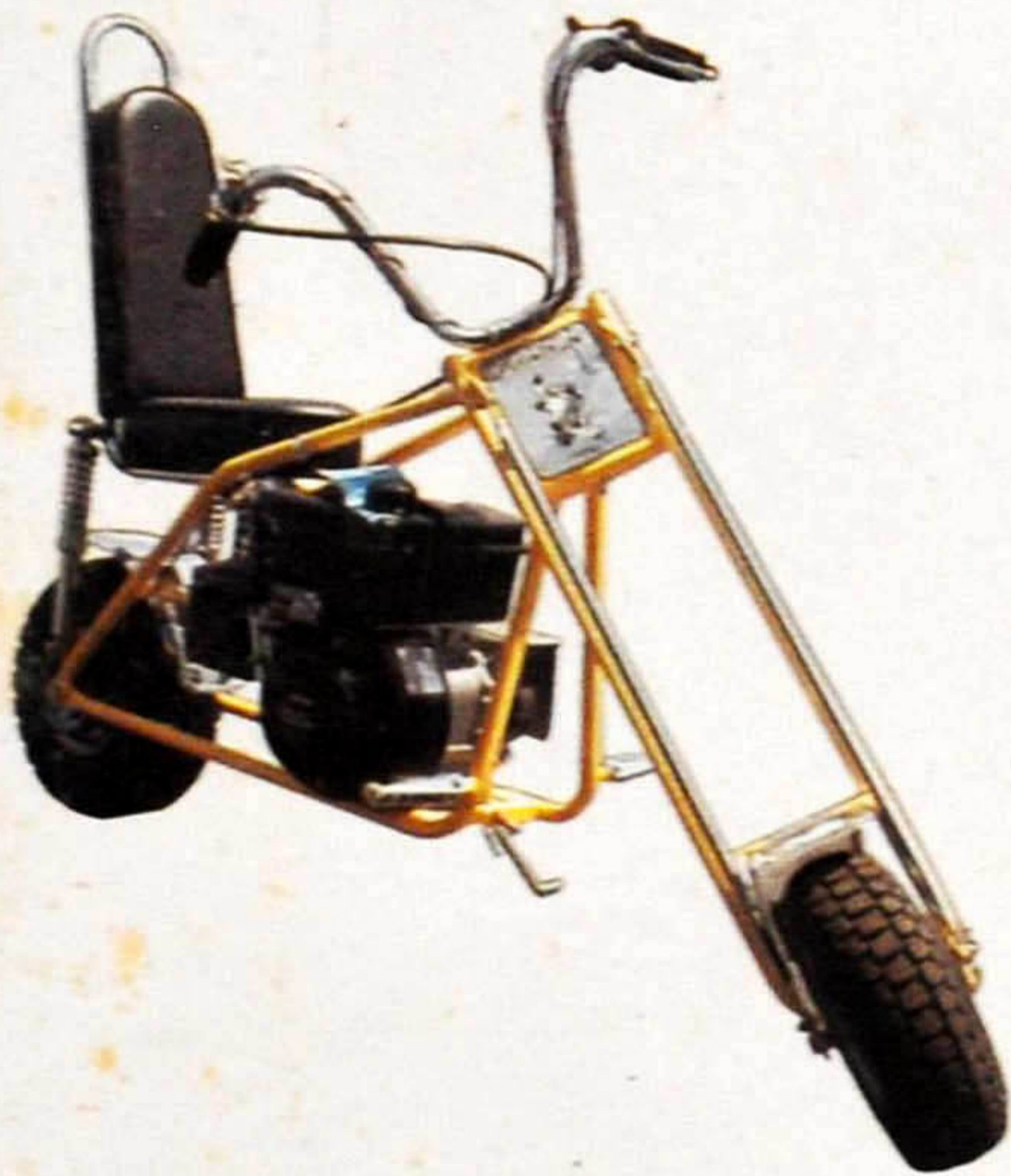

31506 GRAND RIVER AVENUE

*

FARMINGTON, MI 48336

PHONE

(248) 477-0212

\$4.00

FAX

(248) 477-1340

www.recleisure.com

1971

2002

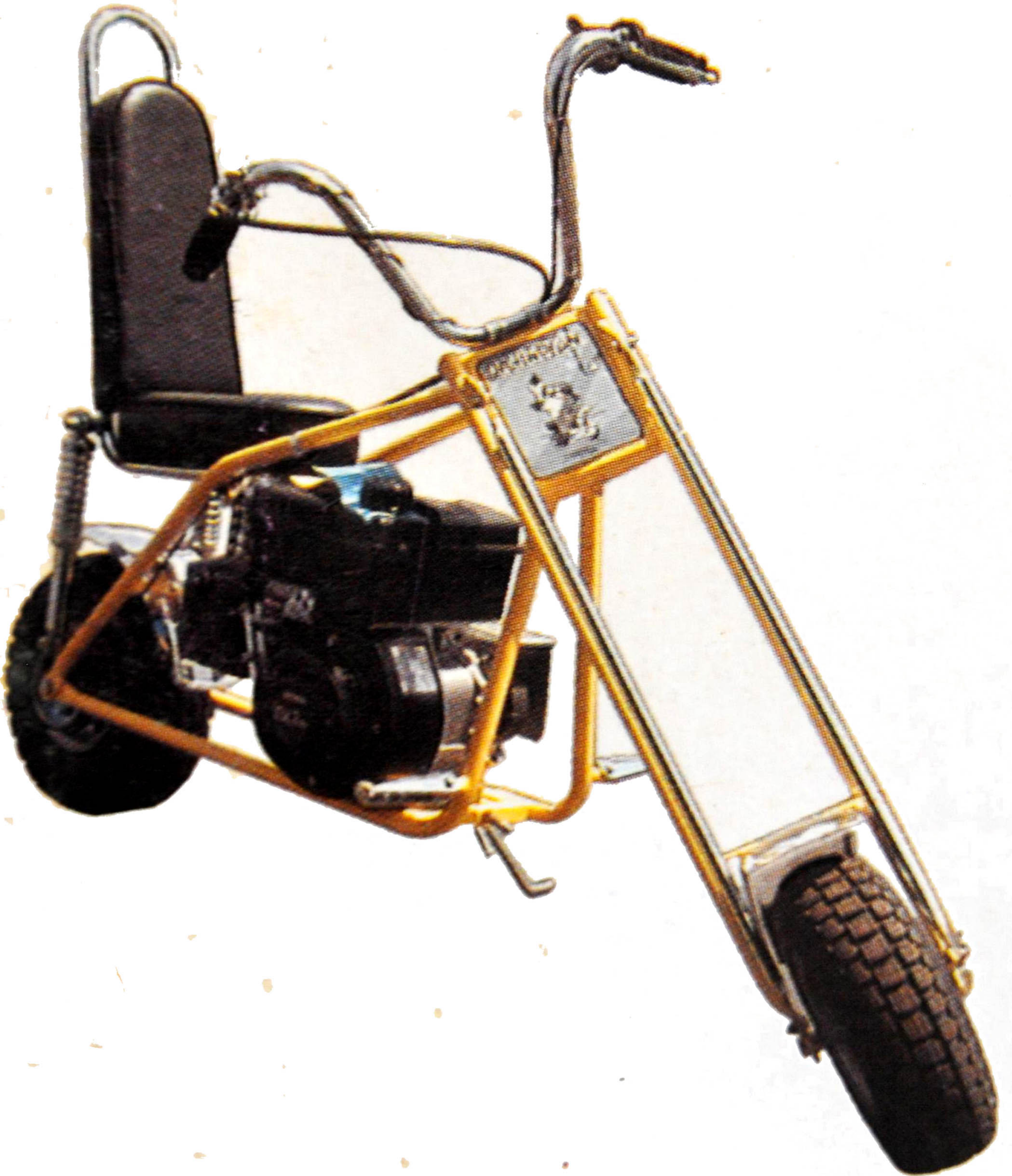



RECREATIONAL LEISURE CORP.

31506 GRAND RIVER AVE. * FARMINGTON, MI 48336

TOLL FREE NUMBER:
1-800-521-6848
FAX NUMBER: (248) 477-1340
www.recleisure.com

"LIL" INDIAN CHOPPER PARTS PACKAGES

To Create Your Own Outlaw II Mini-Bike, Pick One Package From Each Group.

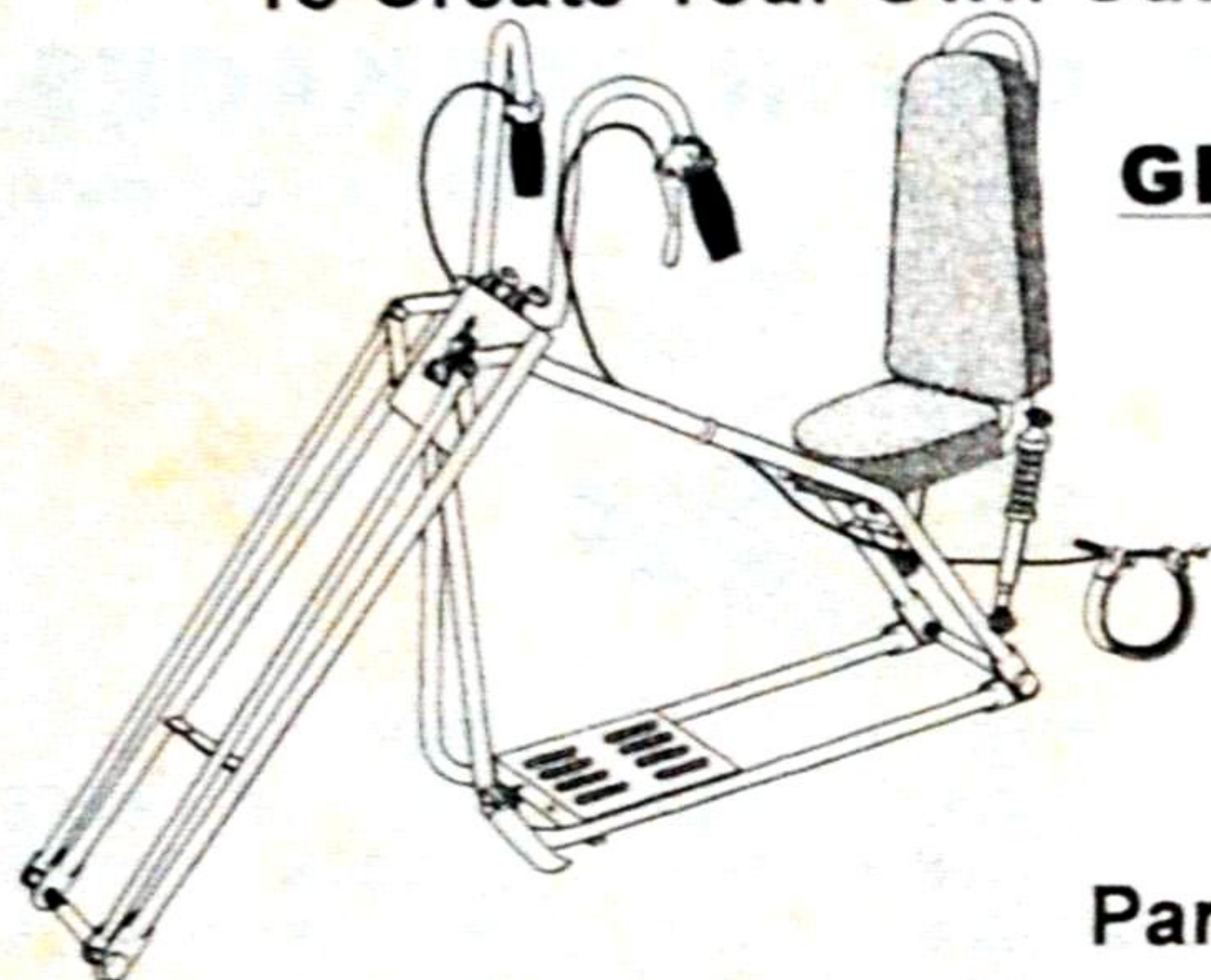

GROUP A: FRAME AND FORK PACKAGES

This package include: frame, fork, seat, throttle control, brake lever and band, foot pegs, front and rear axles, and "Lil" Indian decal. All frames and forks come painted tweety yellow with chrome handlebars and sissy bar. For a complete parts listing see pages 6-7.

Part No. 642000C Outlaw II, (Chopper Frame, Chopper Fork) **\$570.95**

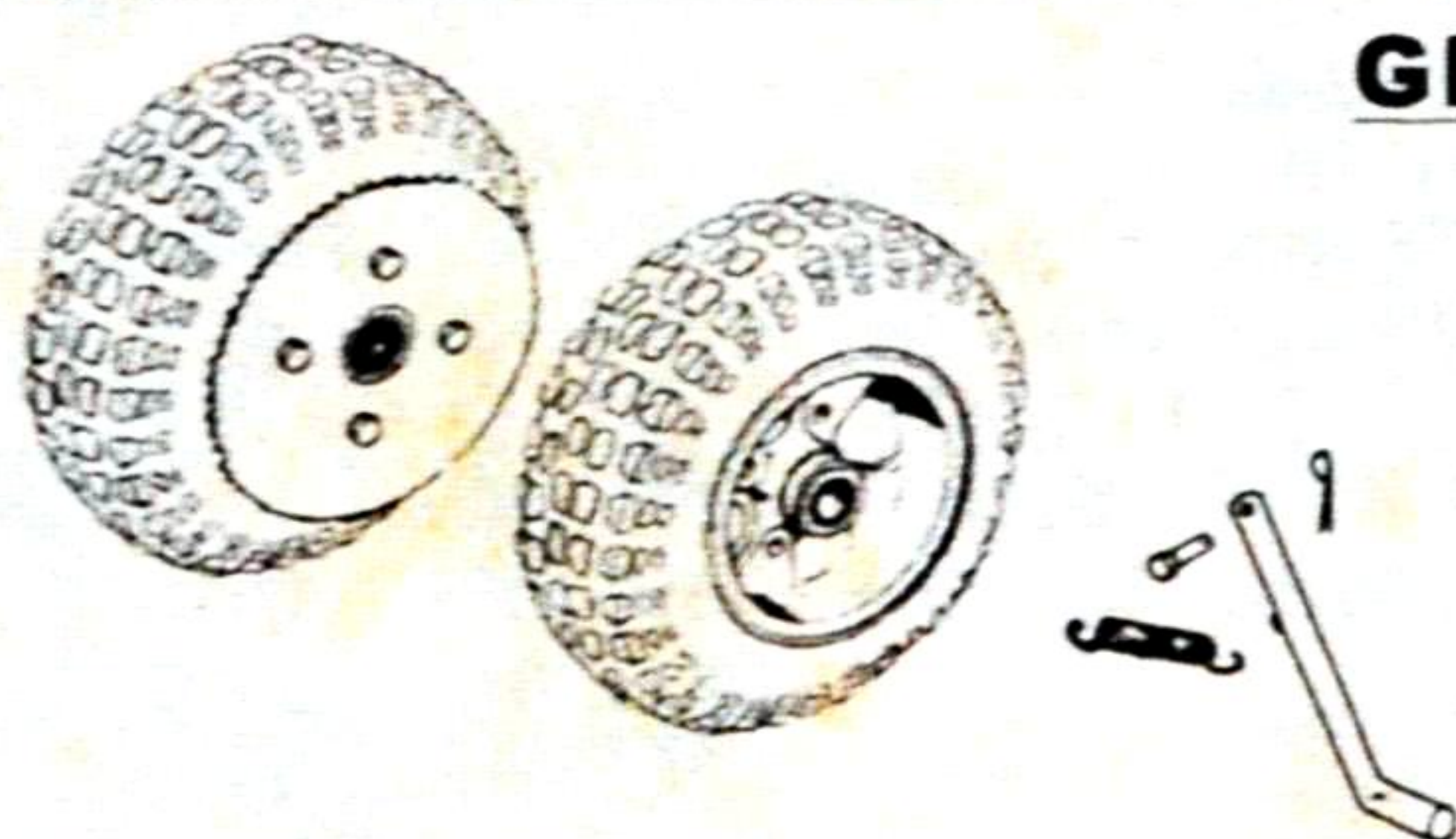

GROUP B: WHEEL PACKAGES

These packages include: front and rear rims, tires, tubes, rear sprocket, axle bushings, spacers, and kick stand. For a complete parts listing see page 9.

Notes: + When using a centrifugal clutch a 72 tooth sprocket is recommended.
@ When using a Torq-A-Verter clutch a 60 tooth sprocket is recommended.

Part No. 400910 + Front: 6" Aluminum Rim with Small Trail Tire, Large Kickstand
Rear: 6" Aluminum Rirn with Large Trail Tire & 72 Tooth Sprocket, Brake Drum **\$179.95**

Part No. 400920 @ Front: 6" Aluminum Rim with Small Trail Tire, Large Kickstand
Rear: 6" Aluminum Rim with Large Trail Tire & 60 Tooth Sprocket, Brake Drum **\$178.95**

GROUP C: FENDER PACKAGES

These packages include: front and rear fenders, nuts and bolts. For a complete parts listing see page 10.

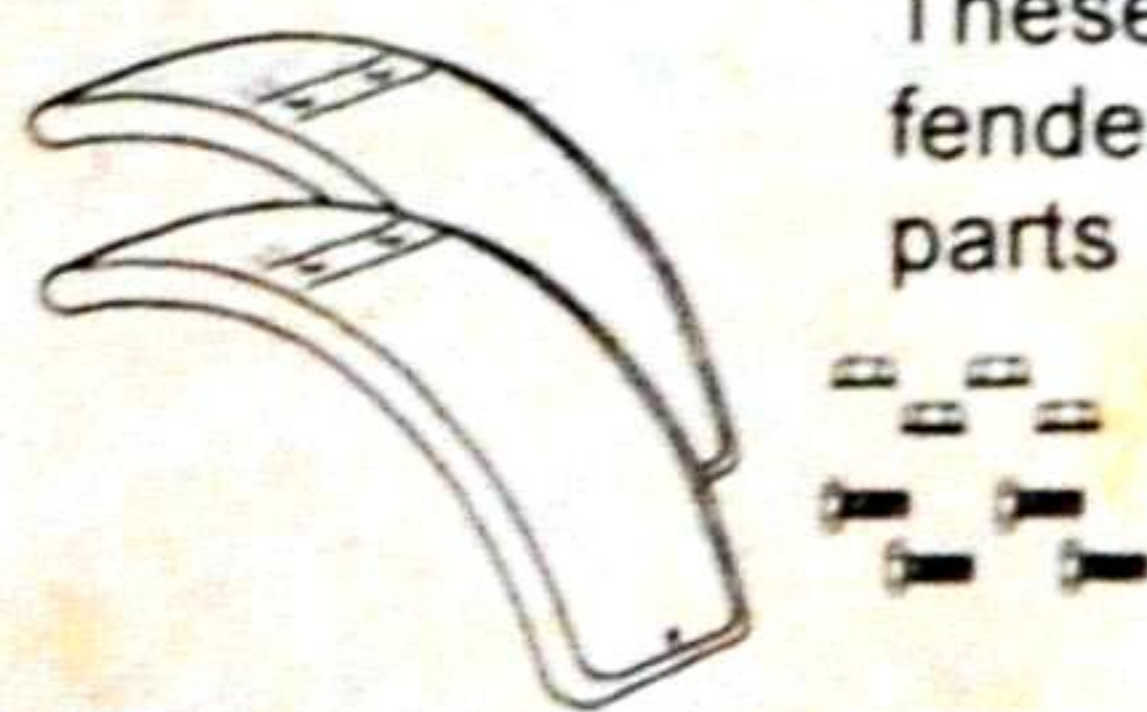

Part No. 400002 Black Plastic Fenders **\$23.95**
Part No. 400004 White Plastic Fenders **\$23.95**
Part No. 400006 Chrome Plastic Fenders **\$32.95**
Part No. 400008 Red Plastic Fenders **\$23.95**

GROUP E: CHAIN PACKAGES

These packages include: pre-cut chain and connecting link.



WHEEL PACKAGES	CHOPPER FRAME W/ CENTRIFUGAL CLUTCH	PRICE	CHOPPER FRAME W/ TORQ-A-VERTER	PRICE
400910	35168CK	\$13.25	----	----
400920	----	----	35126CK	\$10.25

GROUP D: ENGINE & CLUTCH PACKAGES

These packages include: engine, clutch, clutch cover, engine nuts and bolts, and kill switch. For a complete parts listing see page 10.

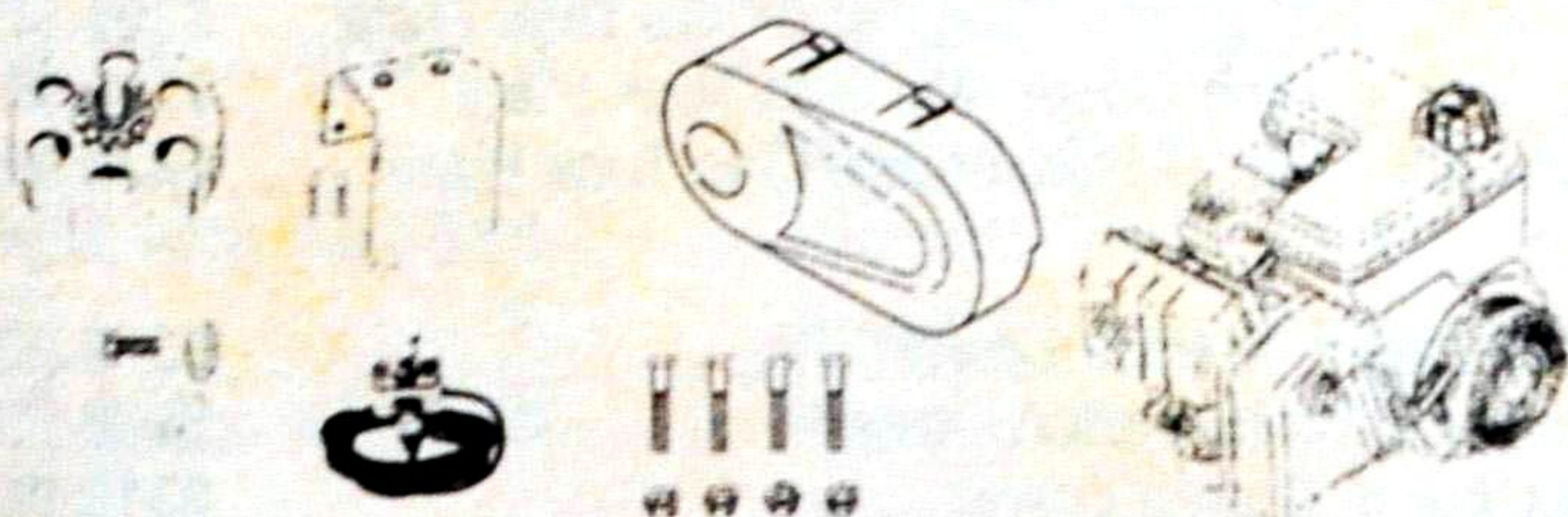

Notes:
+ When using a centrifugal clutch a 72 tooth sprocket is recommended.
@ When using a Torq-A-Verter clutch a 60 tooth sprocket is recommended.

Part No. 500-50 + 5 hp Over Head Valve Tecumseh Engine, Centrifugal Clutch, Clutch Cover **\$322.95**
Part No. 500-55 @ 5 hp Over Head Valve Tecumseh Engine, Torq-A-Verter Clutch, Clutch Cover **\$418.95**
Part No. 500-60 + 6 hp Over Head Valve Tecumseh Engine, Centrifugal Clutch, Clutch Cover **\$341.95**
Part No. 500-65 @ 6 hp Over Head Valve Tecumseh Engine, Torq-A-Verter Clutch, Clutch Cover **\$436.95**



RECREATIONAL LEISURE CORP.

31506 GRAND RIVER AVE. * FARMINGTON, MI 48336

TOLL FREE NUMBER:

1-800-521-6848

FAX NUMBER: (248) 477-1340

www.recleisure.com

GROUP A:

**REPLACEMENT PARTS FOR
OUTLAW II CHOPPER FRAME & FORK PARTS PACKAGES**

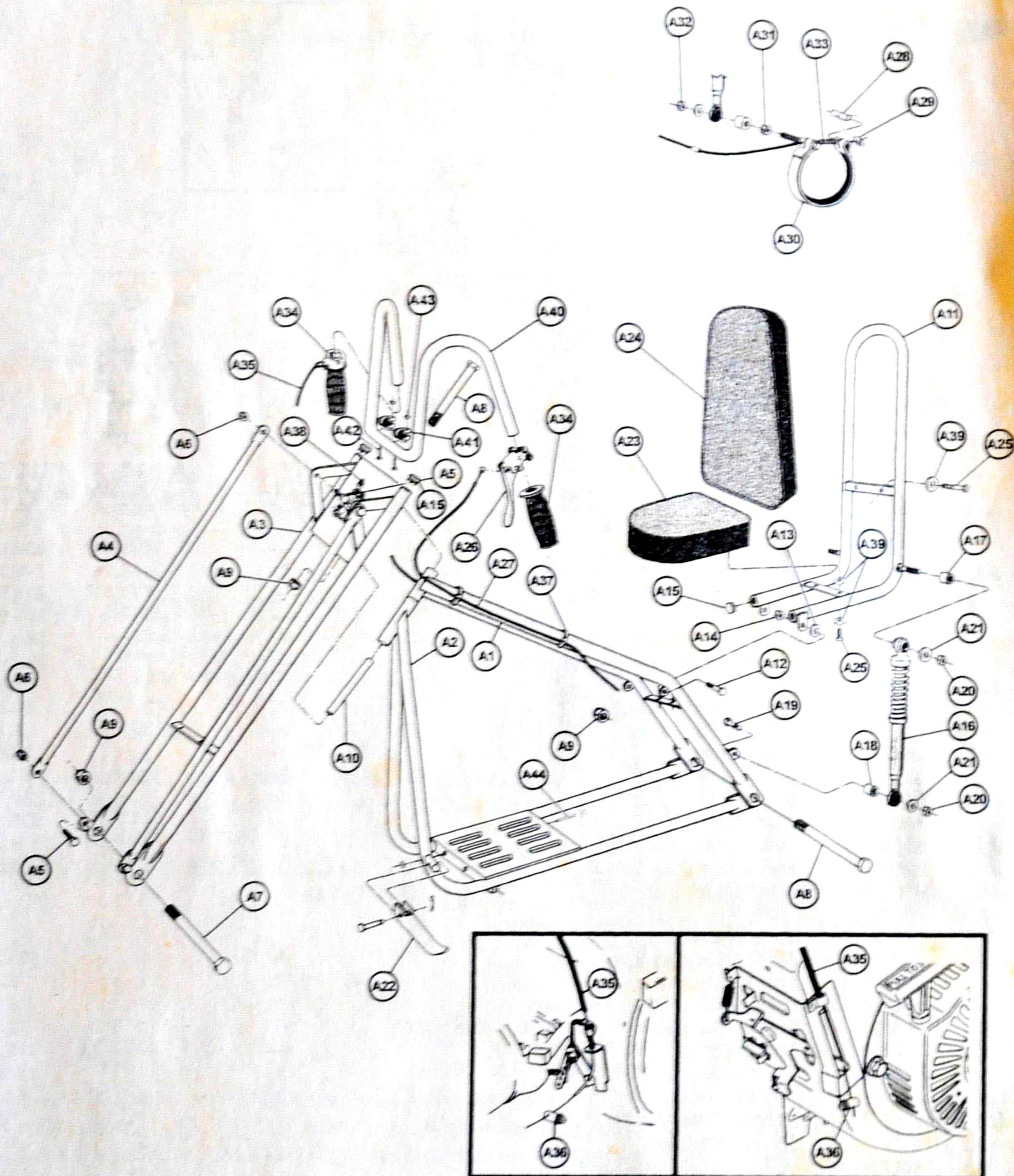



RECREATIONAL LEISURE CORP.

31506 GRAND RIVER AVE. * FARMINGTON, MI 48336

TOLL FREE NUMBER:

1-800-521-6848

FAX NUMBER: (248) 477-1340

www.recleisure.com

REPLACEMENT PARTS FOR

GROUP A: OUTLAW II CHOPPER FRAME & FORK PARTS PACKAGES

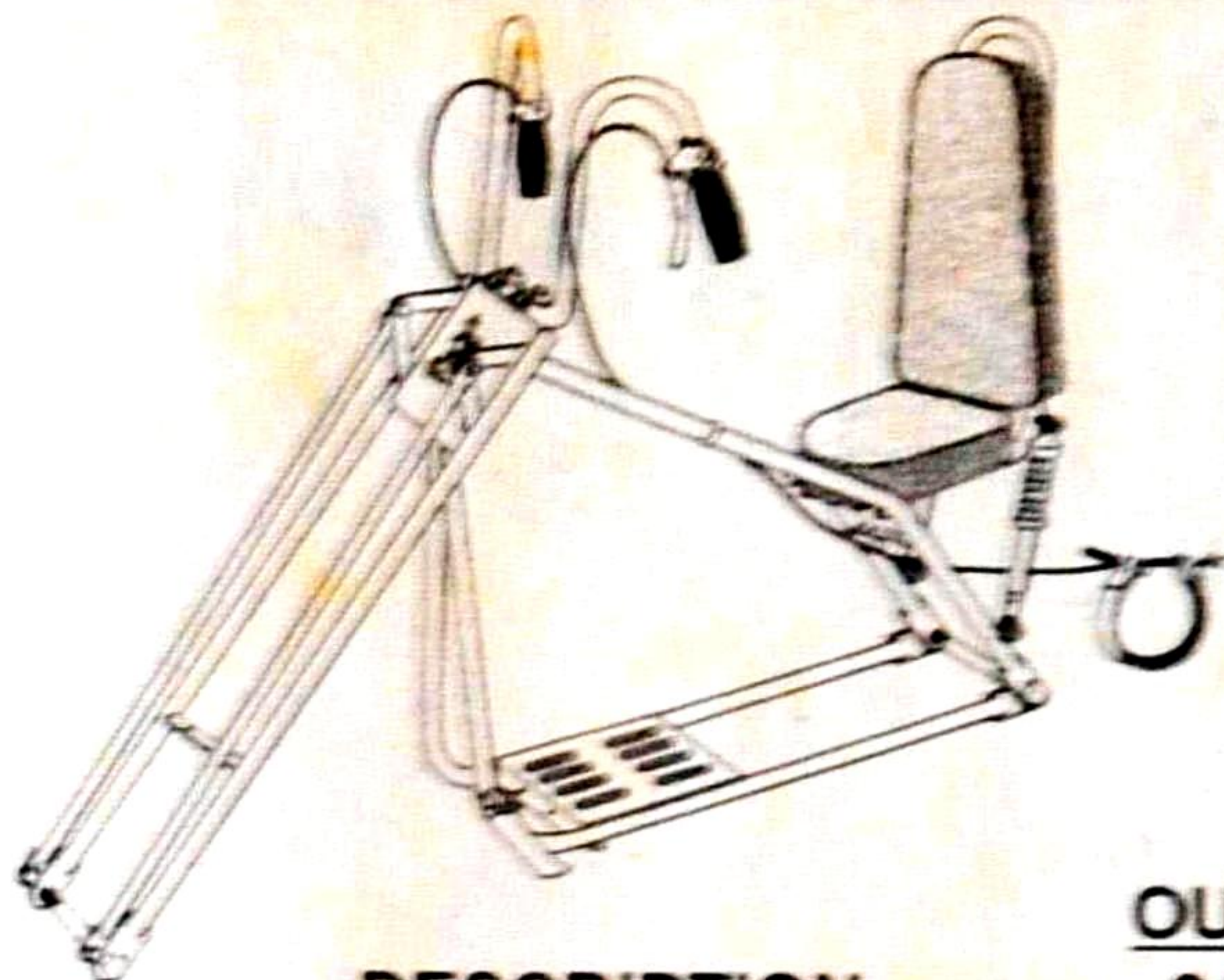

PART NO.		DESCRIPTION	OUTLAW II 642000C	PRICE EACH
A1	1207518	Chopper Frame, Top, Yellow	1	\$57.95
A2	1207519	Chopper Frame, Bottom, Yellow	1	\$73.95
A3	1207520	Chopper Fork Body, Yellow	1	\$62.95
A4	1207680	Fork Strut, Chrome	2	\$19.95
A5	1138542	Fork Strut Bolts	4	\$.35
A6	42302	Fork Strut Nuts	4	\$.25
A7	58190	Axle Bolt	1	\$3.25
A8	58191	Axle and Fork Bolts	2	\$3.25
A9	42402	Axle and Fork Nuts	3	\$.75
A10	63025	Fork Bushing	1	\$4.95
A11	1207523	Sissy Bar, Chrome	1	\$99.95
A12	1138543	Sissy Bar Pivot Bolt	2	\$.30
A13	1206961	Sissy Bar Washer	2	\$.25
A14	42302	Sissy Bar Nut	2	\$.25
A15	1371005	Bar Plugs	4	\$1.50
A16	1700-19	Shocks	2	\$18.95
A17	1724000	Shock Spacer	2	\$.85
A18	1724001	Shock Spacer	2	\$.95
A19	1138587	Shock Bolt	1	\$.40
A20	1163361	Shock Nut	3	\$.35
A21	1162522	Shock Washer	4	\$.15
A22	97029	Foot Peg Kits	2	\$4.95
A23	1600033	Chopper Seat	1	\$35.95
A24	1600032	Chopper Backrest	1	\$43.95
A25	61600	Seat Bolts	4	\$.55
A26	82000	Brake Lever	1	\$3.98
A27	1109260	Brake Cable	1	\$5.95
A28	86000	Brake Pin	1	\$1.75
A29	04-267	Cable Anchor	1	\$.60
A30	1052002	Brake Band with Stud	1	\$23.95
A31	513-375	Brake Band Nut	1	\$.15
A32	1163361	Nyloc Nut	1	\$.35
A33	66500	Brake Return Spring	1	\$.95
A34	1108004	Throttle Control and Grip, Chrome	1	\$12.95
A35	81000	Throttle Cable	1	\$4.95
A36	86101	Throttle Cable Anchor Bolt	1	\$.95
A37	7076	Nylon Cable Ties	2	\$.15
A38	75006C	"LIL" Indian Decal - Silver	1	\$5.95
A39	FW817	Washers	8	\$.05
A40	1207521	Handlebar - Chrome	1	\$45.95
A41	1111500	Handlebar Clamps	2	\$3.95
A42	1142589	Handlebar Bolts	2	\$.95
A43	1163391	Handlebar Nuts	2	\$.35
A44	12107	Motor Mount Adjusting Bolt	1	\$3.95

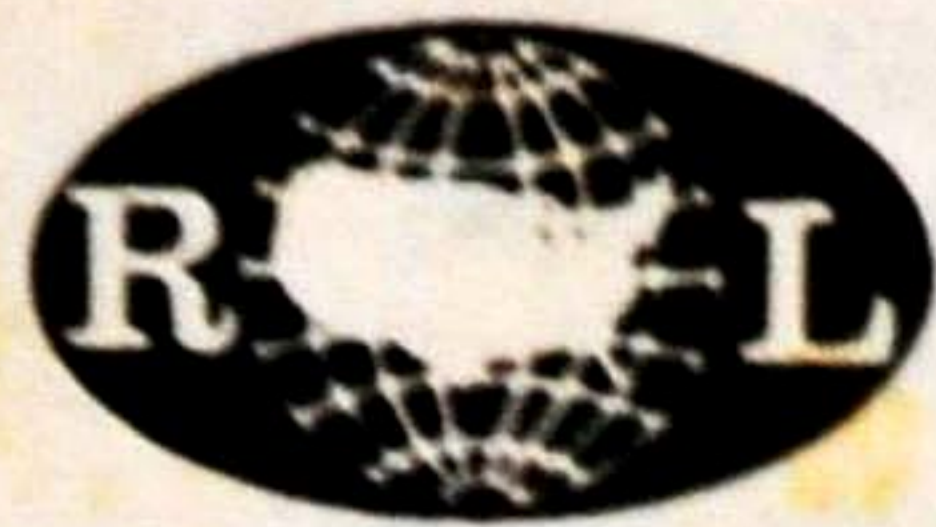

RECREATIONAL LEISURE CORP.

31506 GRAND RIVER AVE. * FARMINGTON, MI 48336

TOLL FREE NUMBER:

1-800-521-6848

FAX NUMBER: (248) 477-1340

www.recleisure.com

REPLACEMENT PARTS FOR

GROUP A: OUTLAW II CHOPPER FRAME & FORK PARTS PACKAGES

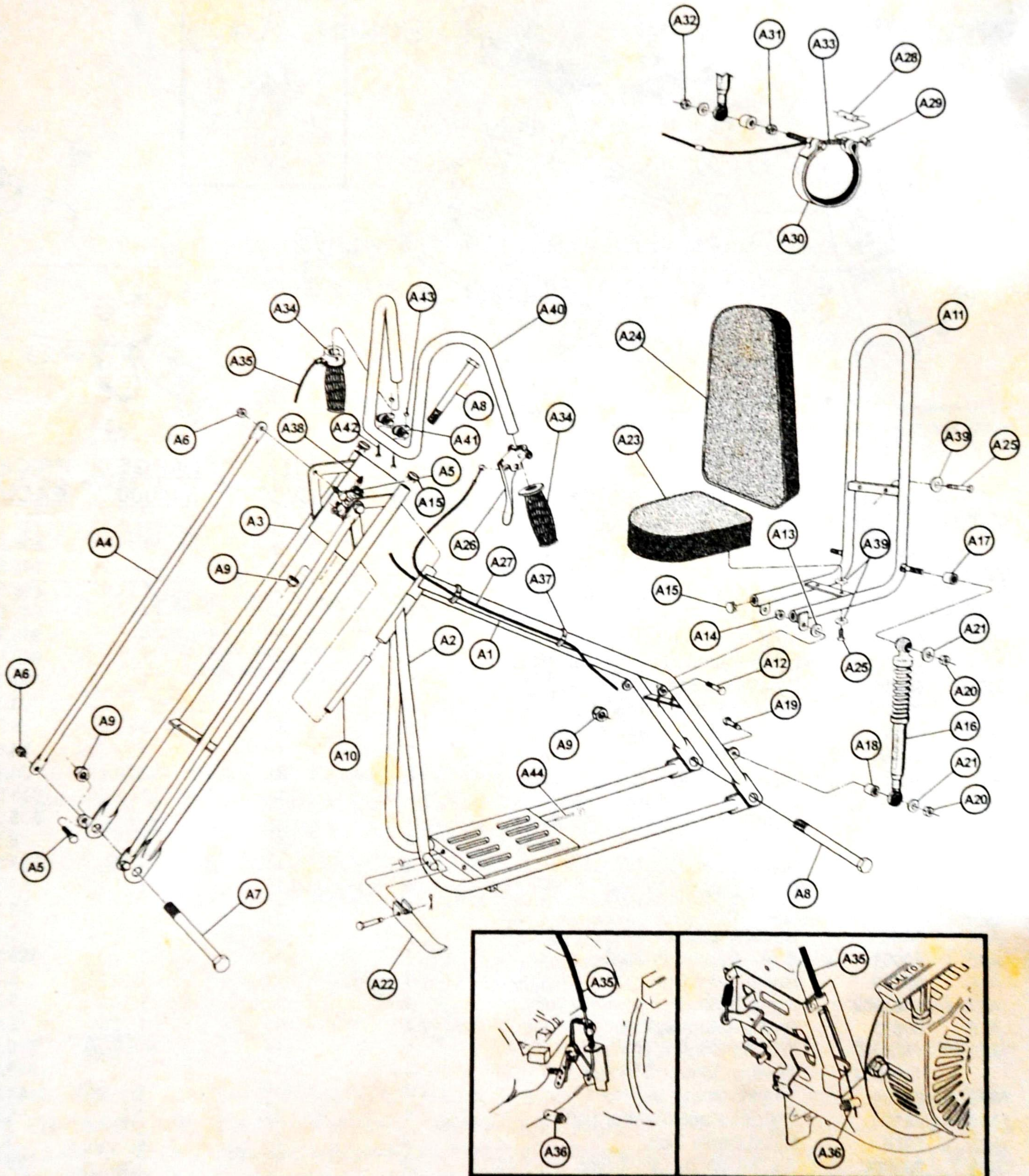



RECREATIONAL LEISURE CORP.

31506 GRAND RIVER AVE. * FARMINGTON, MI 48336

TOLL FREE NUMBER:

1-800-521-6848

FAX NUMBER: (248) 477-1340

www.recleisure.com

REPLACEMENT PARTS FOR

GROUP A: OUTLAW II CHOPPER FRAME & FORK PARTS PACKAGES

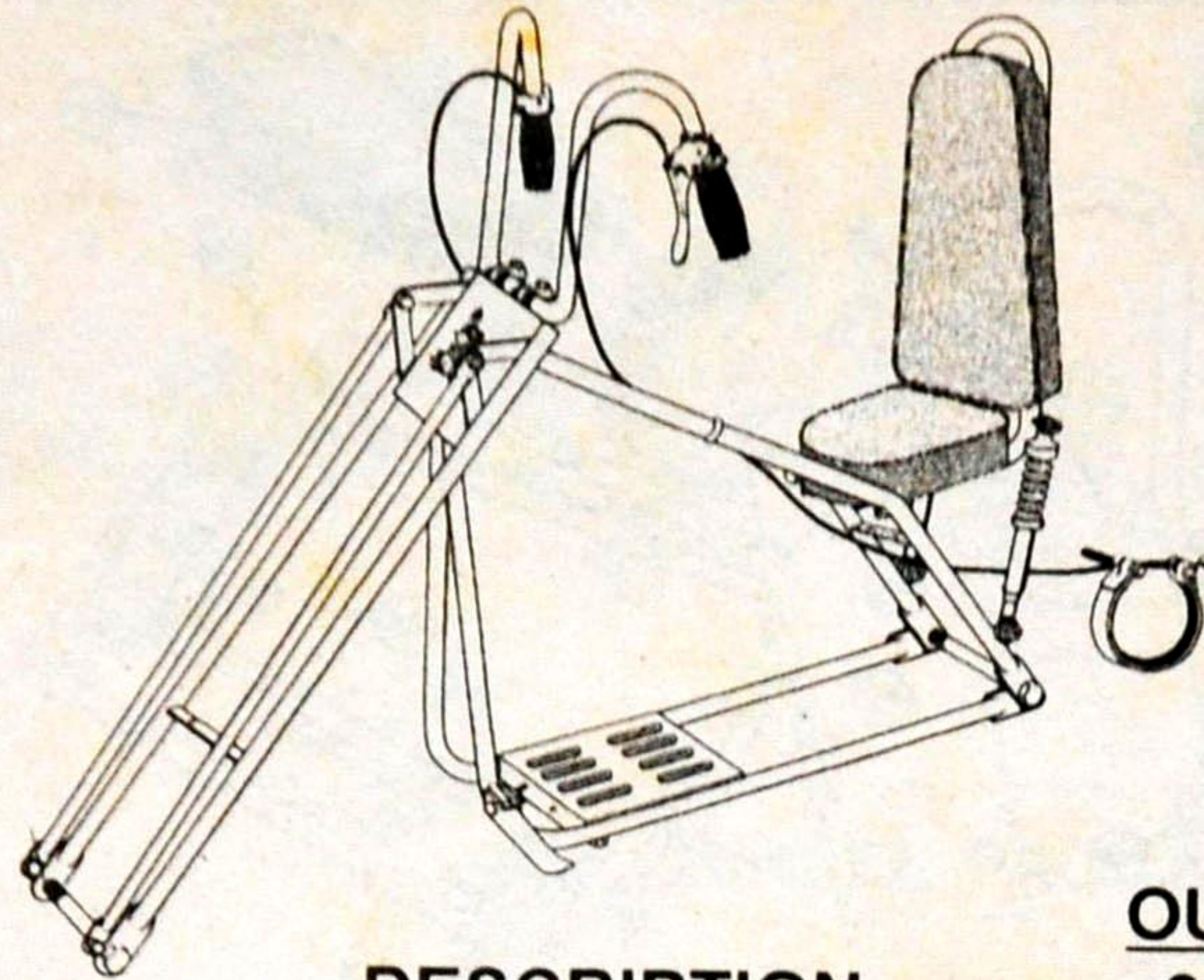

	<u>PART NO.</u>	<u>DESCRIPTION</u>	<u>OUTLAW II 64200C</u>	<u>PRICE EACH</u>
A1	1207518	Chopper Frame, Top, Yellow	1	\$57.95
A2	1207519	Chopper Frame, Bottom, Yellow	1	\$73.95
A3	1207520	Chopper Fork Body, Yellow	1	\$62.95
A4	1207680	Fork Strut, Chrome	2	\$19.95
A5	1138542	Fork Strut Bolts	4	\$.35
A6	42302	Fork Strut Nuts	4	\$.25
A7	58190	Axle Bolt	1	\$3.25
A8	58191	Axle and Fork Bolts	2	\$3.25
A9	42402	Axle and Fork Nuts	3	\$.75
A10	63025	Fork Bushing	1	\$4.95
A11	1207523	Sissy Bar, Chrome	1	\$99.95
A12	1138543	Sissy Bar Pivot Bolt	2	\$.30
A13	1206961	Sissy Bar Washer	2	\$.25
A14	42302	Sissy Bar Nut	2	\$.25
A15	1371005	Bar Plugs	4	\$1.50
A16	1700-19	Shocks	2	\$18.95
A17	1724000	Shock Spacer	2	\$.85
A18	1724001	Shock Spacer	2	\$.95
A19	1138587	Shock Bolt	1	\$.40
A20	1163361	Shock Nut	3	\$.35
A21	1162522	Shock Washer	4	\$.15
A22	97029	Foot Peg Kits	2	\$4.95
A23	1600033	Chopper Seat	1	\$35.95
A24	1600032	Chopper Backrest	1	\$43.95
A25	61600	Seat Bolts	4	\$.55
A26	82000	Brake Lever	1	\$3.98
A27	1109260	Brake Cable	1	\$5.95
A28	86000	Brake Pin	1	\$1.75
A29	04-267	Cable Anchor	1	\$.60
A30	1052002	Brake Band with Stud	1	\$23.95
A31	513-375	Brake Band Nut	1	\$.15
A32	1163361	Nyloc Nut	1	\$.35
A33	66500	Brake Return Spring	1	\$.95
A34	1108004	Throttle Control and Grip, Chrome	1	\$12.95
A35	81000	Throttle Cable	1	\$4.95
A36	86101	Throttle Cable Anchor Bolt	1	\$.95
A37	7076	Nylon Cable Ties	2	\$.15
A38	75006C	"LIL" Indian Decal - Silver	1	\$5.95
A39	FW817	Washers	8	\$.05
A40	1207521	Handlebar - Chrome	1	\$45.95
A41	1111500	Handlebar Clamps	2	\$3.95
A42	1142589	Handlebar Bolts	2	\$.95
A43	1163391	Handlebar Nuts	2	\$.35
A44	12107	Motor Mount Adjusting Bolt	1	\$3.95

"LIL" INDIAN OUTLAW II CHOPPER MINI-BIKE FRAME

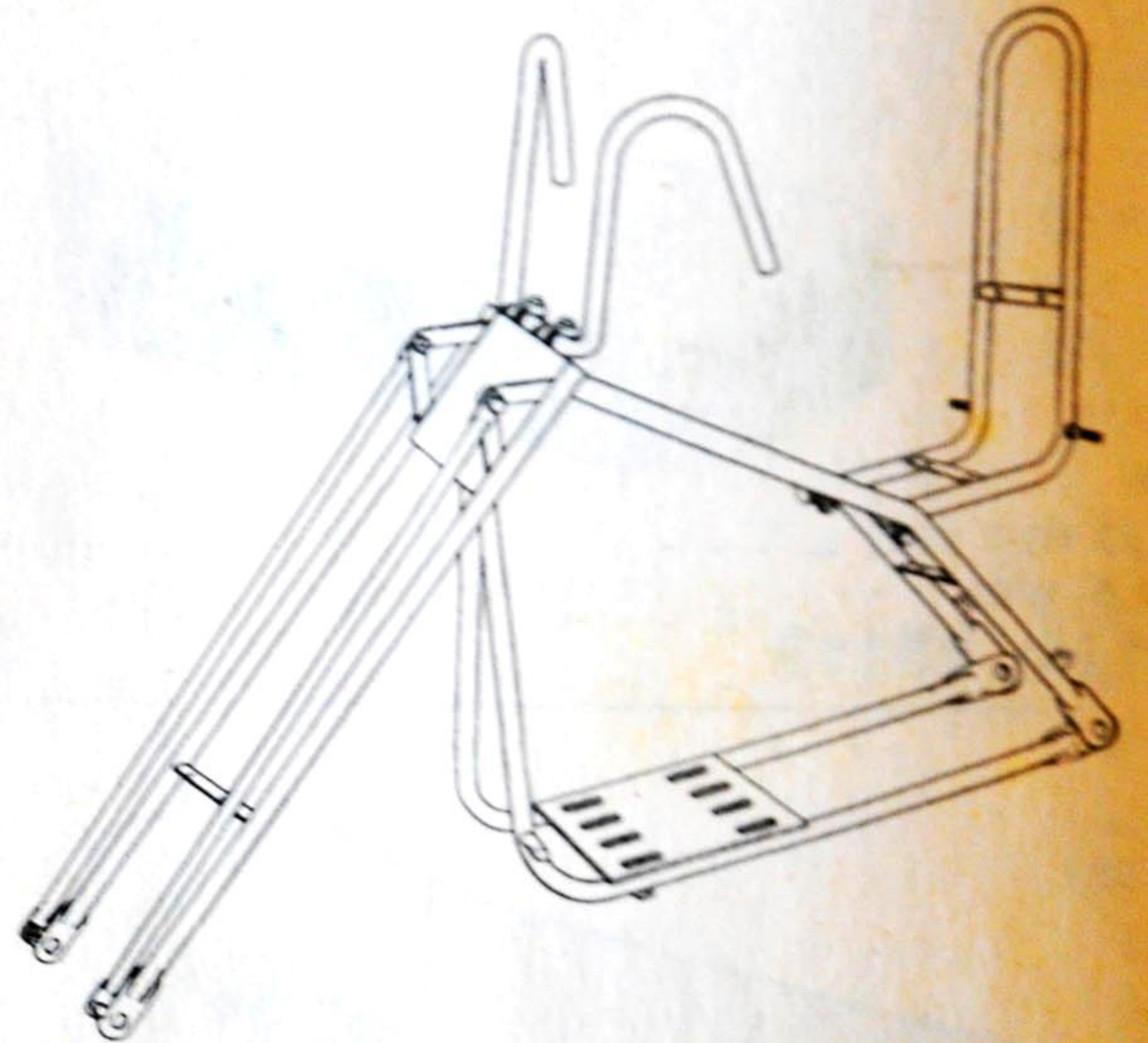
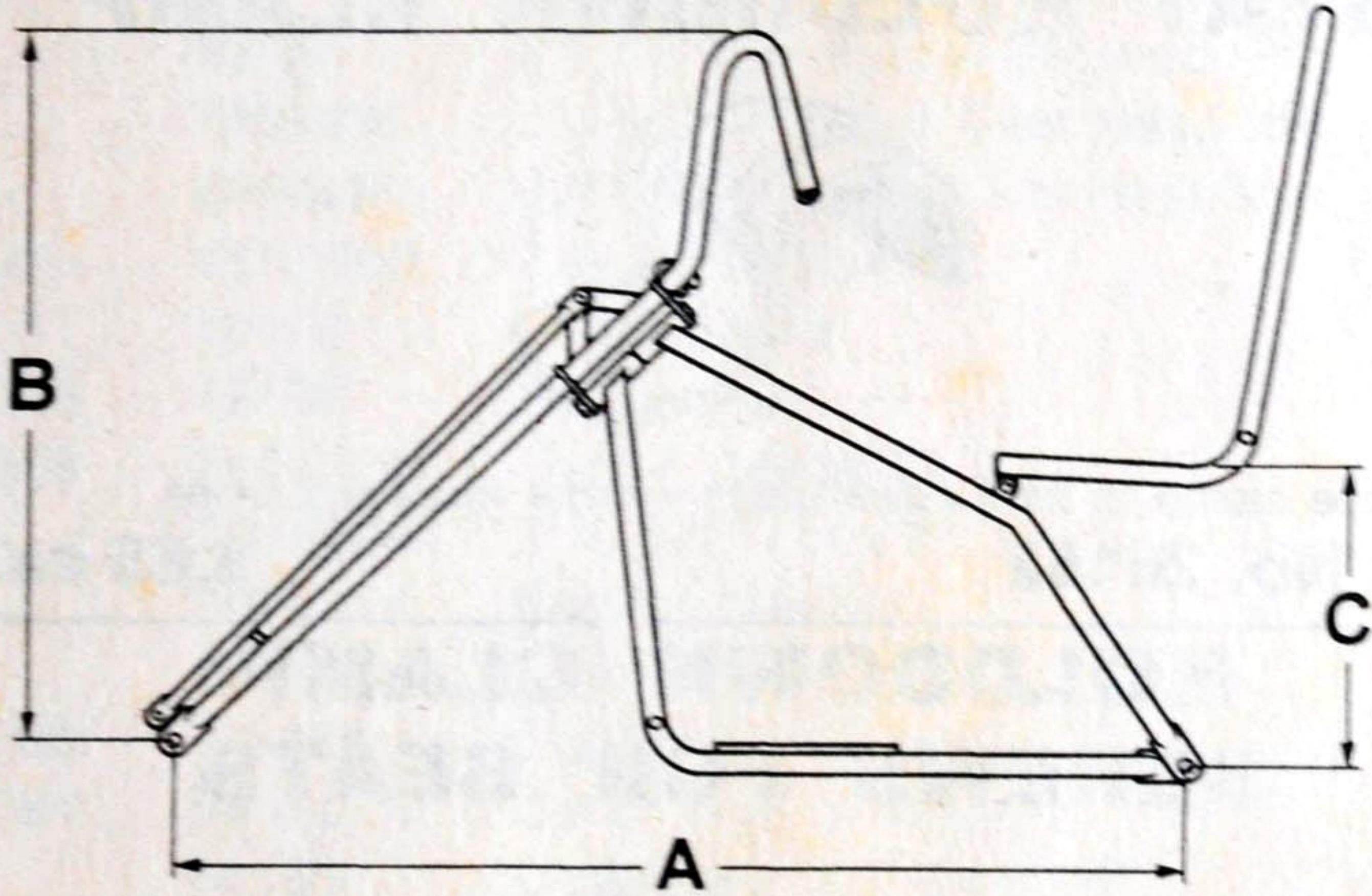

(A)
WHEEL
BASE
50"

(B)
HANDLEBAR
HEIGHT
34"

(C)
SEAT
HEIGHT
14"

PRICE
\$409.95

PART NO.
1345041

DESCRIPTION
Chopper Frame, Standard Fork

* This frame is powder coated tweety yellow.

NEW STYLE "ii" INDIAN OUTLAW II CHOPPER FORK PACKAGE

Includes:

Fork body, handlebars, fork struts, nuts and bolts. This fork is powder coated tweety yellow with chrome handlebars and struts.

Part No. 1800006

\$161.95

