

SUPERSTAR

PARTS and PRICE CATALOG

70-71

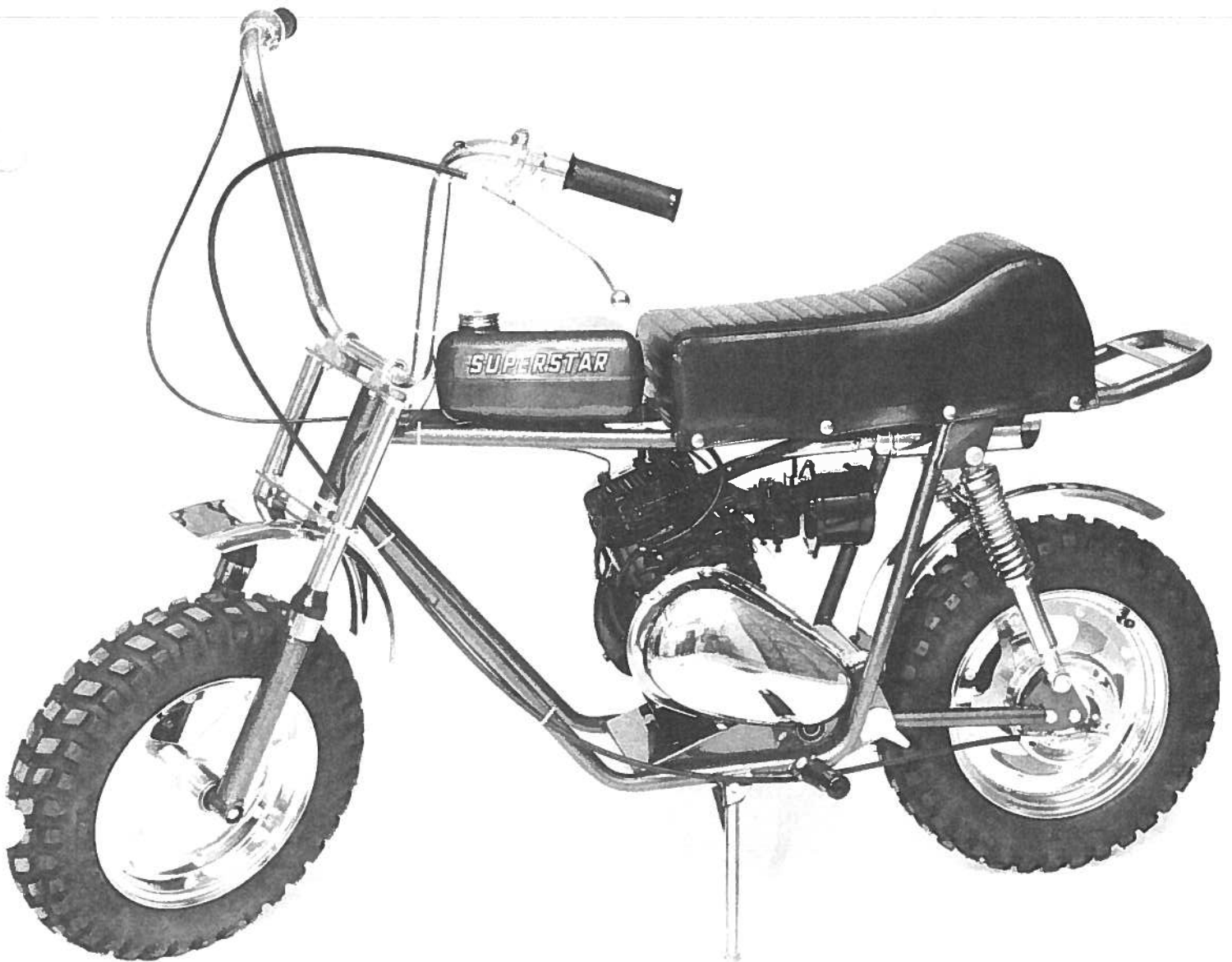

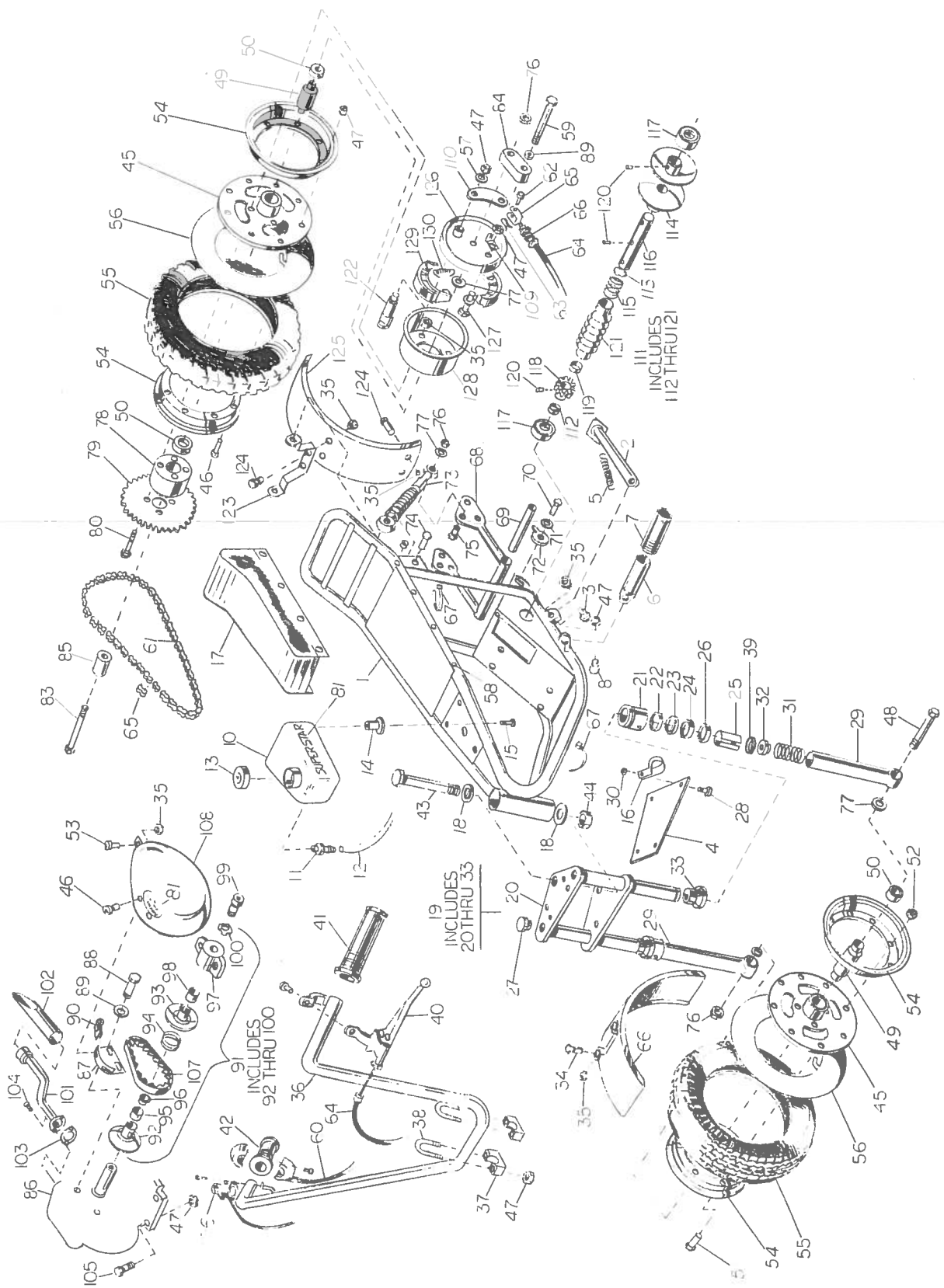

SUPERSTAR PARTS/PRICE LIST

REF.	PART NO.	DESCRIPTION	NO. REQ'D.	REF.	PART NO.	DESCRIPTION	NO. REQ'D.
1	11164	Frame Assembly	1	66	10094	Front Fender	1
2	10130	Kickstand	1	67	10077	Cable Tie	6
3	11178	1/4-20 X 1 1/4" Hex Head Cap Screw	1	68	10373	Swing Arm (Specify Color)	1
4	11173	Dirt Shield	1	69	10073	Pivot Rod	1
5	10134	Kickstand Return Spring	1	70	10535	3/8-24 X 1"Hex Head Cap Screw	2
6	10027	Foot Pedal	2	71	10536	3/8" Split Lock Washer	2
7	10124	Foot Pedal Cover	2	72	10286	Chain Adjusting Cam	2
8	10523	5/16-18 X 1" Hex Head Cap Screw	2	73	10075	Rear Shock Absorber	2
9	11014	Fuel Line Clamp	2	74	10537	3/8-24 X 1 1/2" Hex Head Cap Screw	2
10	11174	Fuel Tank	1	75	10538	3/8-24 X 1 3/8" Hex Head Cap Screw	2
11	10116	Fuel Line Connector	1	76	10533	3/8-24 Cone Lock Nut	7
12	10117	Fuel Line (Specify Length)	1	77	10532	3/8" S. A. E. Flat Washer	7
13	10173	Fuel Tank Cap	1	78	10108	Sprocket Spacer	1
14	11175	Well Nut	3	79	10206	Sprocket, 68 Tooth	1
15	11176	#.10-32X3/4" Fil. Rd. Hd. Mach.	3	80	10539	1/4-24X3 1/4" Hex Hd.Cap Scr.	4
16	10287	Clamp	4	81	10473	Decal,Warning	1
17	11160	Seat	1	82	11204	Decal	2
18	10198	Bearing	2	83	10076	Axle Bolt	1
19	10343	Front Fork Assembly	1	84	10371	Brake Spacer	1
20	10245	Fork Assembly	1	85	10084	Axle Spacer	1
21	10066	Packing Nut	2	86	10148	Engine, HS 40 w/o Alternator	1
22	10437	Bushing	2	87	10120	Torque Converter Guard Bracket	1
23	10064	Shock Tube Seal	2	88	10540	5/16-24X1" Phil. Pan Hd. Mach. Screw	2
24	10253	Shock Tube Seal Retainer	2	89	10541	5/16" Internal Tooth Lock Washer	2
25	11041	Spacer	2	90	10160	Tinnerman Nut	2
26	10443	Spirol Lock Ring	2	91	10089	Drive Converter Assembly	1
27	10081	1/4" N. P. T. Pipe Plug	2	92	10090	Fixed Drive Sheave	1
28	10547	# 10-32 X 7/16" Phillips, Screw	4	93	10091	Movable Driven Sheave	1
29	10059	Lower Shock Tube	2	94	10038	Drive Converter Spring	1
30	10683	# 10-32 Cone Lock Nut	4	95	10037	Belt Roller	1
31	10082	Shock Spring	2	96	10260	Belt Roller Retainer	1
32	10063	Hydraulic Restrictor	2	97	10092	Drive Cover	1
33	10412	Dirt Shield	2	98	10041	Crankshaft Spacer	1
34	10527	1/4-20 X 5/8" Hex Head Cap Screw	2	99	10537	3/8-24 X 1 1/2" Hex Head Cap Screw	1
35	10522	1/4-20 Cone Lock Nut	12	100	10241	3/8" Everlock Washer	1
36	10428	Handlebar	1	101	10125	Exhaust Pipe & Muffler	1
37	10005	Handlebar Clamp	2	102	10126	Muffler Extension	1
38	10001	Handlebar "U" Bolt	2	103	10191	Exhaust Pipe Gasket	1
39	10959	Bushing	2	104	10543	1/4-20X 1/2" Phil. Fillester Hd. Scr.	2
40	10401	Brake Hand Lever	1	105	10544	5/16-18 X 1 1/4" Hex Head Cap Screw	4
41	10056	Dummy Grip	1	106	10141	Kill Button	1
42	10055	Twist Grip Assembly w/Grip	1	107	10098	Drive Belt	1
43	10172	Steering Column Bolt	1	108	10119	Torque Converter Guard	1
44	10528	5/8-18 Cone Lock Nut	1	109	10370	Brake Cable Achor	1
45	10021	Hub and Spoke Assembly	2	110	10369	Brake Actuation Arm	1
46	10962	1/4-20 X 1/2 " Sems Phil. Pan Hd.	2	111	10123	Driven Converter Assembly	1
47	10524	5/16-18 Cone Lock Nut	11	112	10107	Sprocket Spacer	1
48	10076	Axle Bolt	2	113	10368	Brake Actuating Cam	1
49	10080	Bearing Spacer	2	114	10162	Movable Driven Sheave	1
50	10103	Bearing	4	115	10099	Driven Shifler Spring	1
51	10529	5/16-24 X 5/8" Hex Head Cap Screw	16	116	10916	Jackshaft & Sheave	1
52	10524	5/16-18 Cone Lock Nut	16	117	10103	Bearing	2
53	10543	1/4-20 X 1 1/2" Phillips Mach. Screw	1	118	10231	Sprocket, 8 Tooth	1
54	10142	10" Rim w/Hole	2	119	10356	Retainer Spring	1
55	10201	3.50 X 10" Moto Cross Tire	2	120	10244	Drive Pin	3
56	10274	3.50 X 10" Innertube	2	121	10184	Driven Converter Boot	1
57	10548	5/16" S. A. E. Flat Washer	2	122	10233	Jackshift Shim	1
58	10128	Seat Snap	8	123	10087	Rear Fender Bracket	1
59	10549	5/16-18X1-1/2" Hex Hd. Cap Screw	1	124	10546	1/4-20 X 1/2" Hex Head Cap Screw	4
60	10057	Throttle Cable	1	125	10136	Rear Fender	1
61	10228	Chain, 92 Pitch	1	126	10458	Brake Assembly	1
62	10190	Clevis Pin	1	127	10367	Brake Anchor	1
63	10543	3/32 X 1/2" Cotter Pin	1	128	10361	Brake Drum	1
64	10485	Brake Cable w/o Switch	1	129	10374	Brake Shoe, Pair	2
65	10109	Master Link	1	130	10372	Brake Return Spring	1

SUPERSTAR PARTS/PRICE LIST

PART NO.	DESCRIPTION	PRICE	PART NO.	DESCRIPTION	PRICE
10001	Handlebar "U" Bolt	.24	10260	Belt Roller Retainer	.60
10005	Handlebar Clamp	.85	10274	3.50 X 10" Innertube	4.00
10021	Hub and Spoke Assembly	7.80	10286	Chain Adjusting Cam	.25
10027	Foot Pedal	1.10	10287	Clamp	.20
10037	Belt Roller	.90	10343	Front Fork Assembly	27.14
10038	Drive Converter Spring	.40	10356	Retainer Spring	.35
10041	Crankshaft Spacer	.50	10361	Brake Drum	2.10
10055	Twist Grip Assembly w/Grip	3.64	10367	Brake Anchor	.45
10056	Dummy Grip	.65	10368	Brake Actuating Cam	.95
10059	Lower Shock Tube	3.52	10369	Brake Actuating Arm	.50
10063	Hydraulic Restrictor	.30	10370	Brake Cable Anchor	.52
10064	Shock Tube Seal	.40	10371	Brake Spacer	.56
10066	Packing Nut	2.40	10372	Brake Return Spring	.28
10073	Pivot Rod	1.75	10373	Swing Arm (Specify Color)	3.85
10075	Rear Shock Absorber	5.80	10374	Brake Shoe, Pair	3.10
10076	Axle Bolt	1.20	10401	Brake Hand Lever	4.05
10077	Cable Tie	.12	10412	Dirt Shield	.45
10080	Bearing Spacer	1.12	10428	Handlebar	4.75
10081	1/4" N. P. T. Pipe Plug	.10	10437	Bushing	.75
10082	Shock Spring	.50	10443	Spirol Lock Ring	.20
10084	Axle Spacer	.45	10458	Brake Assembly	9.75
10087	Rear Fender Bracket	1.25	10473	Decal, Warning	.25
10089	Drive Converter Assembly	1.55	10485	Brake Cable w/o switch	.08
10090	Fixed Drive Sheave	2.95	10523	5/16-18 X 1" Hex Head Cap Screw	.08
10091	Movable Driven Sheave	3.45	10524	5/16-18 Cone Lock Nut	.08
10092	Drive Cover	3.25	10527	1/4-20 X 5/8" Hex Head Cap Screw	.06
10094	Front Fender	3.10	10528	5/8-18 Cone Lock Nut	.25
10098	Drive Belt	6.56	10529	5/16-18 X 5/8" Hex Head Cap Screw	.08
10099	Driven Shifler Spring	.60	10532	3/8" S. A. E. Flat Washer	.05
10103	Bearing	1.85	10533	3/8-24 Cone Lock Nut	.10
10107	Sprocket Spacer	.30	10534	3/32 X 1/2" Cotter Pin	.05
10108	Sprocket Spacer	1.75	10535	3/8-24 X 1" Hex Head Cap Screw	.10
10109	Master Link	.42	10536	3/8" Split Lock Washer	.05
10116	Fuel Line Connector	.40	10537	3/8-24 X 1 1/2" Hex Head Cap Screw	.10
10117	Fuel Line (Specify Length)	.25	10538	3/8-24 X 1 3/8" Hex Head Cap Screw	.10
10119	Torque Converter Guard	3.00	10539	1/4-20 X 3 1/4" Hex Head Cap Screw	.12
10120	Torque Converter Guard Bracket	1.00	10540	5/16-24X1" Phillips, Pan Head Mach. Scr.	.08
10123	Driven Converter Assembly	12.40	10541	5/16" Internal Tooth Lock Washer	.05
10124	Foot Pedal Cover	.32	10543	1/4-20 X 1/2" Phillips, Fillester Hd. Mach. Scr.	.06
10125	Exhaust Pipe & Muffler	4.15	10544	5/16-18 X 1 1/4" Hex Head Cap Screw	.08
10126	Muffler Extension	3.00	10546	1/4-20 X 1/2" Hex Head Cap Screw	.06
10128	Seat Snap	.05	10547	#10-32 X 7/16" Phillips, Screw	.06
10130	Kickstand	2.00	10548	5/16" S. A. E. Flat Washer	.05
10134	Kickstand Return Spring	.40	10549	5/16-18 X 1 1/2" Hex Head Cap Screw	.08
10136	Rear Fender	2.75	10683	# 10-32 Cone Lock Nut	.20
10141	Kill Button	1.60	10916	Jackshaft & Sheave	4.25
10142	10" Rim w/hole	3.75	10959	Bushing	.50
10148	Engine, HS 40 w/o Alternator	77.55	10962	1/4-20 X 1/2 Sems-Pan Hd. Mach. Screw	.04
10160	Tinnerman Nut	.05	11014	Fuel Line Clamp	.05
10162	Movable Driven Sheave	5.40	11041	Spacer	.15
10172	Steering Column Bolt	.70	11160	Seat	15.25
10173	Fuel Tank Cap	1.00	11164	Frame Assembly	44.65
10184	Driven Converter Boot	.95	11173	Dirt Shield	2.60
10190	Clevis Pin	.30	11174	Fuel Tank	9.25
10191	Exhaust Pipe Gasket	.05	11175	Well Nut	.30
10198	Bearing	.35	11176	No. 10-33 X 3/4" Phillips Rd. Hd. Mach. Scr.	.03
10201	3.50 X 10" Moto Cross Tire	16.80	11178	1/4-20 X 1 1/4" Hex Head Cap Screw	.05
10206	Sprocket , 68 Tooth	7.40	11204	Decal	.45
10228	Chain, 92 Pitch	8.05			
10231	Sprocket, 8 Tooth	2.90			
10233	Jackshaft Shim	.20			
10241	3/8" Everlock Washer	.10			
10244	Drive Pin	.10			
10245	Fork Assembly	14.75			
10253	Shock Tube Seal Retainer	.25			

SPEEDWAY PRODUCTS, INC. 160 E. LONGVIEW AVE. MANSFIELD, OHIO

Division of Taylor Metal Products Co.